

A-INFO

Waveguide Components

- Straight Waveguide
- Bend Waveguide
- Twist Waveguide
- Waveguide to Coaxial Adapter
- Waveguide Transition
- Waveguide Coupler
- Waveguide Tee
- Waveguide Joint
- Waveguide Dummy Load
- Waveguide Attenuator
- Waveguide Circulator
- Waveguide Isolator
- Electric Dual Ridge W/G Switch
- Waveguide Short Plates
- 1/4 Waveguide Offset Short
- Flexible Waveguide
- Flexible Twist Waveguide
- Elliptical Waveguide

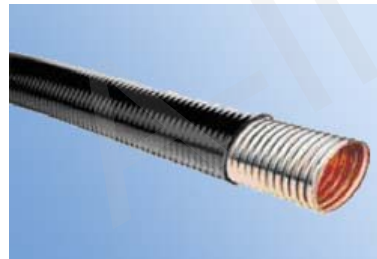
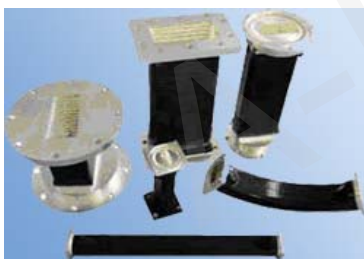
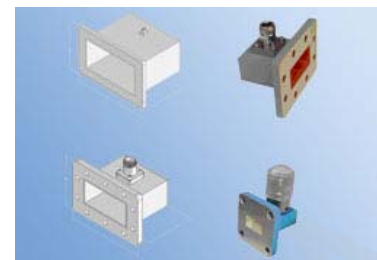
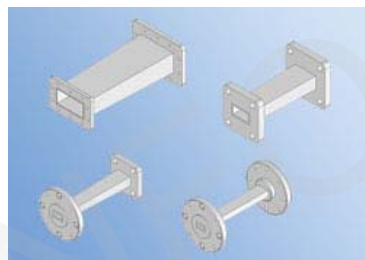
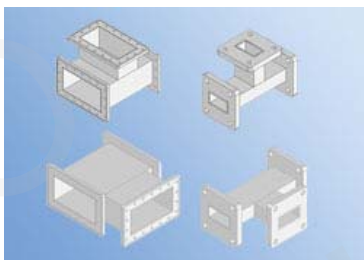
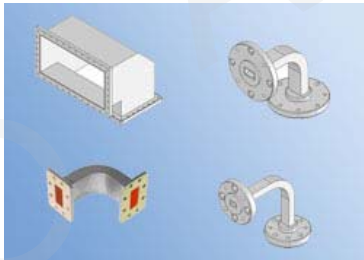

Content

STRAIGHT WAVEGUIDE	2
DOUBLE RIDGE STRAIGHT WAVEGUIDE	3
RADIUS BEND WAVEGUIDE(90° E-PLANE)	4
RADIUS BEND WAVEGUIDE(90° H-PLANE).....	5
MITER BEND WAVEGUIDE (90° E-PLANE).....	6
MITER BEND WAVEGUIDE (90° H-PLANE)	7
DOUBLE RIDGE BEND WAVEGUIDE.....	8
TWIST WAVEGUIDE.....	9
DOUBLE RIDGE TWIST WAVEGUIDE.....	10
RIGHT ANGLE WAVEGUIDE TO COAXIAL ADAPTER	11
ENDLAUNCH WAVEGUIDE TO COAXIAL ADAPTER.....	12
DOUBLE RIDGE WAVEGUIDE TO COAXIAL ADAPTER	14
HIGH POWER DOUBLE RIDGE WAVEGUIDE TO COAXIAL ADAPTER.....	15
WAVEGUIDE TRANSITION.....	16
WAVEGUIDE CROSS COUPLER(W+C-XX TYPE)	18
WAVEGUIDE CROSS COUPLER(WL+C-XX TYPE)	20
WAVEGUIDE CROSS COUPLER(WL+CN-XX TYPE)	22
WAVEGUIDE HIGH DIRECTIONAL COUPLER (WC-XX TYPE)	24
WAVEGUIDE HIGH DIRECTIONAL COUPLER(WCN-XX TYPE).....	26
WAVEGUIDE HIGH DIRECTIONAL COUPLER (WIC-XX TYPE).....	28
WAVEGUIDE HIGH DIRECTIONAL COUPLER (WYC-XX TYPE).....	30
WAVEGUIDE HIGH DIRECTIONAL COUPLER (WICN-XX TYPE)	32
WAVEGUIDE LOOP COUPLER (WHC-XX TYPE)	35
WAVEGUIDE LOOP COUPLER (WHHC-XX TYPE).....	36
WAVEGUIDE LOOP COUPLER (WDHC-XX TYPE).....	37
WAVEGUIDE LOOP COUPLER (WDHHC-XX TYPE).....	38
WAVEGUIDE MAGIC TEE.....	39
WAVEGUIDE ET	41
WAVEGUIDE HT.....	42
WAVEGUIDE SINGLE JOINT (I TYPE)	43
WAVEGUIDE SINGLE JOINT (U TYPE)	44
WAVEGUIDE SINGLE JOINT (L TYPE).....	45
WAVEGUIDE LOW POWER LOAD	46
WAVEGUIDE MEDIUM POWER LOAD	47

WAVEGUIDE HIGH POWER LOAD.....	48
WAVEGUIDE FIXED ATTENUATOR	49
WAVEGUIDE VARIABLE ATTENUATOR	50
WAVEGUIDE CIRCULATOR.....	51
WAVEGUIDE ISOLATOR	52
ELECTRIC DOUBLE RIDGE WAVEGUIDE SWITCH	53
WAVEGUIDE SHORT PLATES.....	54
1/4 WAVEGUIDE OFFSET SHORT	55
FLEXIBLE WAVEGUIDE.....	56
FLEXIBLE TWIST WAVEGUIDE	57
ELLIPTICAL WAVEGUIDE	58

Chengdu AINFO Inc. is an ISO 9001:2000 certified manufacturer.



Straight Waveguide

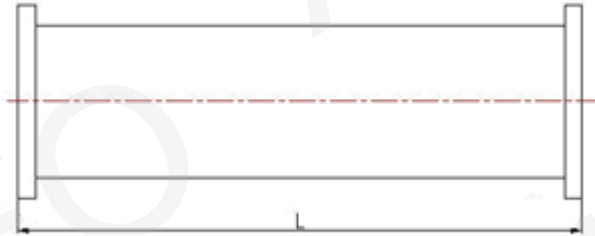
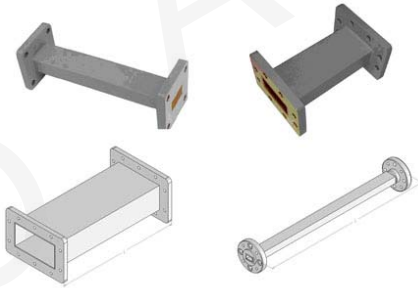

Standard Models

P/N	Frequency Range (GHz)	Waveguide	VSWR	Length (mm)	Flange	Material
975WAL-500	0.75-1.12	WR975	1.05	500	FDP9	Al
770WAL-500	0.96-1.45	WR770	1.05	500	FDP12	Al
650WAL-500	1.12-1.70	WR650	1.05	500	FDP14/FDM14	Al
510WAL-500	1.45-2.20	WR510	1.05	500	FDP18/FDM18	Al
430WAL-500	1.70-2.60	WR430	1.05	500	FDP22/FDM22	Al/Cu
340WAL-500	2.20-3.30	WR340	1.05	500	FDP26/FDM26	Al/Cu
284WAL-200	2.60-3.95	WR284	1.05	200	FDP32/FDM32	Al/Cu
229WAL-200	3.30-4.90	WR229	1.05	200	FDP40/FDM40	Al/Cu
187WAL-200	3.95-5.85	WR187	1.05	200	FDP48/FDM48	Al/Cu
159WAL-200	4.90-7.05	WR159	1.05	200	FDP58/FDM58	Al/Cu
137WAL-200	5.85-8.20	WR137	1.05	200	FDP70/FDM70	Al/Cu
112WAL-200	7.05-10.0	WR112	1.05	200	FBP84/FBM84/FBE84	Al/Cu
90WAL-100	8.20-12.4	WR90	1.05	100	FBP100/FBM100/FBE100	Al/Cu
75WAL-100	10.0-15.0	WR75	1.05	100	FBP120/FBM120/FBE120	Al/Cu
62WAL-100	12.4-18.0	WR62	1.05	100	FBP140/FBM140/FBE140	Al/Cu
51WAL-100	15.0-22.0	WR51	1.05	100	FBP180/FBM180/FBE180	Al/Cu
42WAL-100	18.0-26.5	WR42	1.05	100	FBP220/FBM220/FBE220	Al/Cu
34WAL-100	22.0-33.0	WR34	1.05	100	FBP260/FBM260/FBE260	Al/Cu
28WAL-100	26.5-40.0	WR28	1.05	100	FBP320/FBM320/FBE320	Al/Cu
22WAL-50	33.0-50.0	WR22	1.10	50	FUGP400	Cu
19WAL-50	40.0-60.0	WR19	1.10	50	FUGP500	Cu
15WAL-50	50.0-75.0	WR15	1.10	50	FUGP620	Cu
12WAL-50	60.0-90.0	WR12	1.10	50	FUGP740	Cu
10WAL-50	75.0-110.0	WR10	1.10	50	FUGP900	Cu

Ordering Information

P/N:

975 **WAL** - **L**
 WR Size Product Code Length (mm)

Example: 975WAL-500 is a WR975 straight waveguide. Length is 500mm.

AINFO manufactures wide variety of straight waveguide assemblies specially designed for every customers unique requirements. Straight Waveguide can be assembled with many types of flange. We also offer many other special configurations, length and hole size to meet special requirements.

Note:

1. Customization is available;
2. For detailed information of each straight waveguide, please visit the website: www.ainfoinc.com

Double Ridge Straight Waveguide

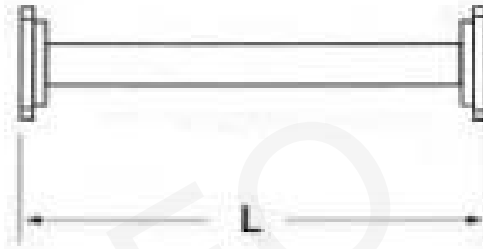

Standard Models				
P/N	Frequency Range (GHz)	Waveguide	VSWR	Length (XXX) (mm)
250DRWAL-XXX	2.6-7.8	WRD250D30	1.15	Customized
350DRWAL-XXX	3.5-8.2	WRD350D24	1.15	Customized
475DRWAL-XXX	4.75-11.0	WRD475D24	1.15	Customized
580DRWAL-XXX	5.8-16.0	WRD580D28	1.15	Customized
650DRWAL-XXX	6.5-18.0	WRD650D28	1.15	Customized
750DRWAL-XXX	7.5-18.0	WRD750D24	1.15	Customized
180DRWAL-XXX	18.0-40.0	WRD180C24	1.15	Customized

<p>Ordering Information</p> <p>P/N:</p> <p style="text-align: center;"> <u>250</u> <u>DRWAL</u> - <u>XXX</u> WR Size Product Code Length (mm) </p> <p>Example: 250DRWAL-500 is a WRD250D30 double ridge straight waveguide. Length is 500mm.</p> <p>Note:</p> <ol style="list-style-type: none"> 1. Customization is available; 2. For detailed information of each double ridge straight waveguide, please visit the website: www.ainfoinc.com 		<p>AINFO manufactures wide variety of double ridge straight waveguide assemblies specially designed for every customers unique requirements. Double Ridge Straight Waveguide can be assembled with many types of flange. We also offer many other special configurations, length and hole size to meet special requirements.</p>
---	--	--

Radius Bend Waveguide(90° E-Plane)

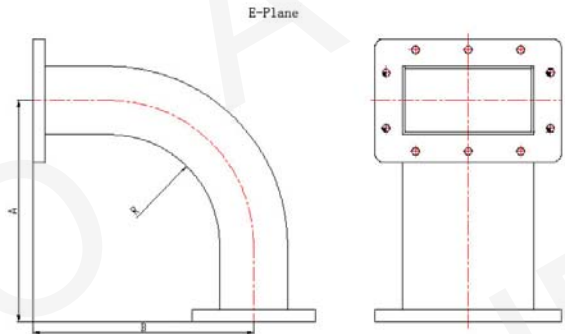

Standard Models					
P/N	Frequency Range (GHz)	Waveguide	VSWR	Flange	Material
430WEB-190-190-95	1.70-2.60	WR430	1.15	FDP22/FDM22	Al/Cu
340WEB-100-100-40	2.20-3.30	WR340	1.15	FDP26/FDM26	Al/Cu
284WEB-100-100-40	2.60-3.95	WR284	1.15	FDP32/FDM32	Al/Cu
229WEB-80-80-40	3.30-4.90	WR229	1.15	FDP40/FDM40	Al/Cu
187WEB-80-80-40	3.95-5.85	WR187	1.15	FDP48/FDM48	Al/Cu
159WEB-80-80-40	4.90-7.05	WR159	1.15	FDP58/FDM58	Al/Cu
137WEB-60-60-30	5.85-8.20	WR137	1.15	FDP70/FDM70	Al/Cu
112WEB-50-50-25	7.05-10.0	WR112	1.15	FBP84/FBM84/FBE84	Al/Cu
90WEB-40-40-20	8.20-12.4	WR90	1.15	FBP100/FBM100/FBE100	Al/Cu
75WEB-40-40-20	10.0-15.0	WR75	1.15	FBP120/FBM120/FBE120	Al/Cu
62WEB-40-40-20	12.4-18.0	WR62	1.15	FBP140/FBM140/FBE140	Al/Cu
51WEB-30-30-15	15.0-22.0	WR51	1.15	FBP180/FBM180/FBE180	Al/Cu
42WEB-30-30-15	18.0-26.5	WR42	1.15	FBP220/FBM220/FBE220	Al/Cu
34WEB-30-30-15	22.0-33.0	WR34	1.15	FBP260/FBM260/FBE260	Al/Cu
28WEB-25-25-10	26.5-40.0	WR28	1.15	FBP320/FBM320/FBE320	Al/Cu
22WEB-25-25-10	33.0-50.0	WR22	1.15	FUGP400	Cu
19WEB-25-25-10	40.0-60.0	WR19	1.15	FUGP500	Cu
15WEB-20-20-10	50.0-75.0	WR15	1.15	FUGP620	Cu
12WEB-20-20-10	60.0-90.0	WR12	1.15	FUGP740	Cu
10WEB-20-20-10	75.0-110.0	WR10	1.15	FUGP900	Cu

Ordering Information

P/N:

430 **WEB** - **A** - **B** - **R**
 WR Product Size A Size B Size R
 Size Code (mm) (mm) (mm)

Example: 430WEB-190-190-95 is a WR430 90° E-Plane Radius Bend Waveguide. Size A is 190mm, B is 190mm, R is 95mm.

AINFO manufactures wide variety of radius bend waveguide assemblies specially designed for every customers unique requirements. Radius Bend Waveguide can be assembled with many types of flange. Basic styles in bend include miter and radius 90° bends, acute and obtuse E-plane and H-plane bends in angles from 30° to 180°.

Note:

1. Customization is available;
2. For detailed information of each 90° E-Plane radius bend waveguide, please visit the website: www.ainfoinc.com.

Radius Bend Waveguide(90° H-Plane)

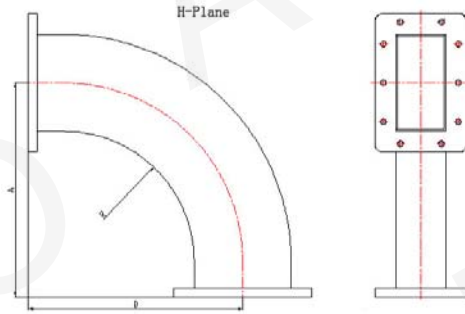

Standard Models					
P/N	Frequency Range (GHz)	Waveguide	VSWR	Flange	Material
430WHB-250-250-152	1.70-2.60	WR430	1.15	FDP22/FDM22	Al/Cu
340WHB-180-180-100	2.20-3.30	WR340	1.15	FDP26/FDM26	Al/Cu
284WHB-160-160-100	2.60-3.95	WR284	1.15	FDP32/FDM32	Al/Cu
229WHB-120-120-78	3.30-4.90	WR229	1.15	FDP40/FDM40	Al/Cu
187WHB-80-80-40	3.95-5.85	WR187	1.15	FDP48/FDM48	Al/Cu
159WHB-80-80-40	4.90-7.05	WR159	1.15	FDP58/FDM58	Al/Cu
137WHB-80-80-50	5.85-8.20	WR137	1.15	FDP70/FDM70	Al/Cu
112WHB-60-60-35	7.05-10.0	WR112	1.15	FBP84/FBM84/FBE84	Al/Cu
90WHB-55-55-35	8.20-12.4	WR90	1.15	FBP100/FBM100/FBE100	Al/Cu
75WHB-45-45-30	10.0-15.0	WR75	1.15	FBP120/FBM120/FBE120	Al/Cu
62WHB-40-40-25	12.4-18.0	WR62	1.15	FBP140/FBM140/FBE140	Al/Cu
51WHB-35-35-20	15.0-22.0	WR51	1.15	FBP180/FBM180/FBE180	Al/Cu
42WHB-35-35-20	18.0-26.5	WR42	1.15	FBP220/FBM220/FBE220	Al/Cu
34WHB-35-35-20	22.0-33.0	WR34	1.15	FBP260/FBM260/FBE260	Al/Cu
28WHB-30-30-15	26.5-40.0	WR28	1.15	FBP320/FBM320/FBE320	Al/Cu
22WHB-20-20-10	33.0-50.0	WR22	1.15	FUGP400	Cu
19WHB-25-25-10	40.0-60.0	WR19	1.15	FUGP500	Cu
15WHB-25-25-10	50.0-75.0	WR15	1.15	FUGP620	Cu
12WHB-25-25-10	60.0-90.0	WR12	1.15	FUGP740	Cu
10WHB-25-25-10	75.0-110.0	WR10	1.15	FUGP900	Cu

Ordering Information

P/N:

430 WHB - A - B - R
 WR Product Size A Size B Size R
 Size Code (mm) (mm) (mm)

Example: 430WHB-250-250-152 is a WR430 90° H-Plane Radius Bend Waveguide. Size A is 250mm, B is 250mm, R is 152mm.

AINFO manufactures wide variety of radius bend waveguide assemblies specially designed for every customers unique requirements. Radius Bend Waveguide can be assembled with many types of flange. Basic styles in bend include miter and radius 90° bends, acute and obtuse E-plane and H-plane bends in angles from 30° to 180°.

Note:

1. Customization is available;
2. For detailed information of each 90° H-Plane radius bend waveguide, please visit the website: www.ainfoinc.com.

Miter Bend Waveguide (90° E-Plane)

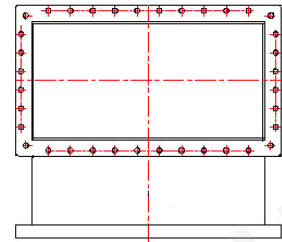
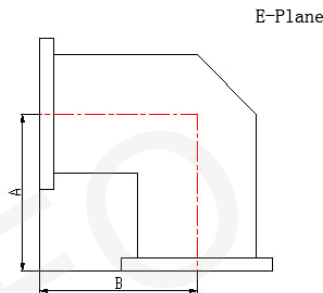
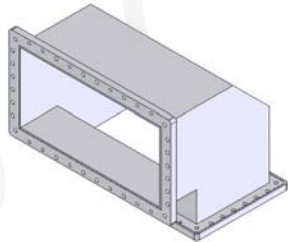

Standard Models

P/N	Frequency Range (GHz)	Waveguide	VSWR	Flange	Material
975WTEB-150-150	0.75-1.12	WR975	1.15	FDP9	Al
770WTEB-100-100	0.96-1.45	WR770	1.15	FDP12	Al
650WTEB-100-100	1.12-1.70	WR650	1.15	FDP14/FDM14	Al
510WTEB-80-80	1.45-2.20	WR510	1.15	FDP18/FDM18	Al/Cu
430WTEB-80-80	1.70-2.60	WR430	1.15	FDP22/FDM22	Al/Cu
340WTEB-60-60	2.20-3.30	WR340	1.15	FDP26/FDM26	Al/Cu
284WTEB-50-50	2.60-3.95	WR284	1.15	FDP32/FDM32	Al/Cu
229WTEB-40-40	3.30-4.90	WR229	1.15	FDP40/FDM40	Al/Cu
187WTEB-40-40	3.95-5.85	WR187	1.15	FDP48/FDM48	Al/Cu
159WTEB-40-40	4.90-7.05	WR159	1.15	FDP58/FDM58	Al/Cu
137WTEB-30-30	5.85-8.20	WR137	1.15	FDP70/FDM70	Al/Cu
112WTEB-25-25	7.05-10.0	WR112	1.15	FBP84/FBM84/FBE84	Al/Cu
90WTEB-20-20	8.20-12.4	WR90	1.15	FBP100/FBM100/FBE100	Al/Cu
75WTEB-20-20	10.0-15.0	WR75	1.15	FBP120/FBM120/FBE120	Al/Cu
62WTEB-20-20	12.4-18.0	WR62	1.15	FBP140/FBM140/FBE140	Al/Cu
51WTEB-20-20	15.0-22.0	WR51	1.15	FBP180/FBM180/FBE180	Al/Cu
42WTEB-20-20	18.0-26.5	WR42	1.15	FBP220/FBM220/FBE220	Al/Cu
34WTEB-20-20	22.0-33.0	WR34	1.15	FBP260/FBM260/FBE260	Al/Cu
28WTEB-15-15	26.5-40.0	WR28	1.15	FBP320/FBM320/FBE320	Al/Cu

Ordering Information

P/N:

340 **WTEB** - **A** - **B**
 WR Size Product Code Size A (mm) Size B (mm)

Example: 340WTEB-60-60 is a WR340 90° E-Plane Miter Bend Waveguide. Size A is 60mm, B is 60mm.

AINFO manufactures wide variety of miter bend waveguide assemblies specially designed for every customers unique requirements. Miter Bend Waveguide can be assembled with many types of flange. Basic styles in bend include miter and radius 90° bends.

Note:

1. Customization is available;
2. For detailed information of each 90° E-Plane miter bend waveguide, please visit the website: www.ainfoinc.com.

Miter Bend Waveguide (90° H-Plane)

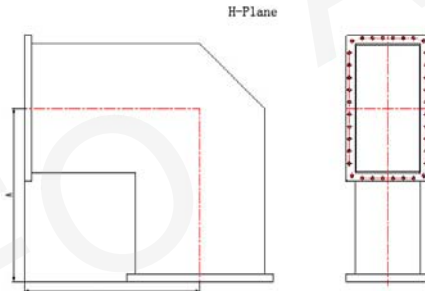

Standard Models					
P/N	Frequency Range (GHz)	Waveguide	VSWR	Flange	Material
975WTHB-250-250	0.75-1.12	WR975	1.15	FDP9	Al
770WTHB-200-200	0.96-1.45	WR770	1.15	FDP12	Al
650WTHB-180-180	1.12-1.70	WR650	1.15	FDP14/FDM14	Al
510WTHB-150-150	1.45-2.20	WR510	1.15	FDP18/FDM18	Al/Cu
430WTHB-80-80	1.70-2.60	WR430	1.15	FDP22/FDM22	Al/Cu
340WTHB-60-60	2.20-3.30	WR340	1.15	FDP26/FDM26	Al/Cu
284WTHB-50-50	2.60-3.95	WR284	1.15	FDP32/FDM32	Al/Cu
229WTHB-40-40	3.30-4.90	WR229	1.15	FDP40/FDM40	Al/Cu
187WTHB-40-40	3.95-5.85	WR187	1.15	FDP48/FDM48	Al/Cu
159WTHB-40-40	4.90-7.05	WR159	1.15	FDP58/FDM58	Al/Cu
137WTHB-30-30	5.85-8.20	WR137	1.15	FDP70/FDM70	Al/Cu
112WTHB-25-25	7.05-10.0	WR112	1.15	FBP84/FBM84/FBE84	Al/Cu
90WTHB-20-20	8.20-12.4	WR90	1.15	FBP100/FBM100/FBE100	Al/Cu
75WTHB-20-20	10.0-15.0	WR75	1.15	FBP120/FBM120/FBE120	Al/Cu
62WTHB-20-20	12.4-18.0	WR62	1.15	FBP140/FBM140/FBE140	Al/Cu
51WTHB-20-20	15.0-22.0	WR51	1.15	FBP180/FBM180/FBE180	Al/Cu
42WTHB-20-20	18.0-26.5	WR42	1.15	FBP220/FBM220/FBE220	Al/Cu
34WTHB-20-20	22.0-33.0	WR34	1.15	FBP260/FBM260/FBE260	Al/Cu
28WTHB-15-15	26.5-40.0	WR28	1.15	FBP320/FBM320/FBE320	Al/Cu

Ordering Information

P/N:

340 **WTHB** - **A** - **B**
 WR Size Product Code Size A (mm) Size B (mm)

Example: 340WTHB-60-60 is a WR340 90° H-Plane Miter Bend Waveguide. Size A is 60mm, B is 60mm.

Note:

1. Customization is available;
2. For detailed information of each 90° H-Plane miter bend waveguide, please visit the website: www.ainfoinc.com.

AINFO manufactures wide variety of miter bend waveguide assemblies specially designed for every customers unique requirements. Miter Bend Waveguide can be assembled with many types of flange. The available materials include brass and aluminum. Basic styles in bend include miter and radius 90° bends.

Double Ridge Bend Waveguide

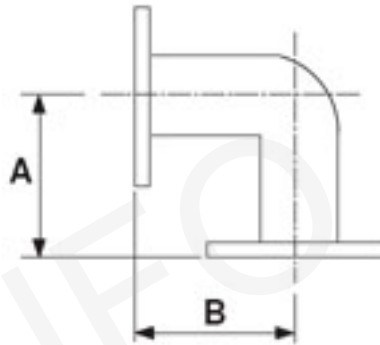

Standard Models				
P/N	Frequency Range (GHz)	Waveguide	VSWR	Size A,B (mm)
650DRWB-A-B	6.5-18.0	WRD650D28	1.20	Customized
750DRWB-A-B	7.5-18.0	WRD750D24	1.20	Customized

Ordering Information P/N: 650 DRWB - A - B WR Size Product Code Size A (mm) Size B (mm)		AINFO manufactures wide variety of double ridge bend waveguide assemblies specially designed for every customers unique requirements. Double Ridge Bend Waveguide can be assembled with many types of flange. We also offer many other special configurations, length and hole size to meet special requirements.
Example: 650DRWB-100-100 is a WRD650D28 double ridge Bend waveguide. Size A is 100mm, B is 100mm.		
Note: 1. Customization is available; 2. For detailed information of each double ridge bend waveguide, please visit the website: www.ainfoinc.com		

Twist Waveguide

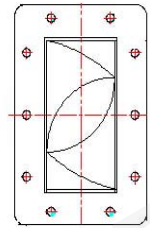
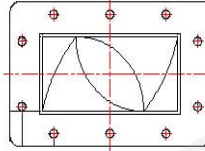

Standard Models

P/N	Frequency Range (GHz)	Waveguide	VSWR	Length (mm)	Flange	Material
430WTA-800	1.70-2.60	WR430	1.10	800	FDP22/FDM22	Al/Cu
340WTA-500	2.20-3.30	WR340	1.10	500	FDP26/FDM26	Al/Cu
284WTA-300	2.60-3.95	WR284	1.10	300	FDP32/FDM32	Al/Cu
229WTA-250	3.30-4.90	WR229	1.10	250	FDP40/FDM40	Al/Cu
187WTA-200	3.95-5.85	WR187	1.10	200	FDP48/FDM48	Al/Cu
159WTA-200	4.90-7.05	WR159	1.10	200	FDP58/FDM58	Al/Cu
137WTA-150	5.85-8.20	WR137	1.10	150	FDP70/FDM70	Al/Cu
112WTA-120	7.05-10.0	WR112	1.10	120	FBP84/FBM84/FBE84	Al/Cu
90WTA-100	8.20-12.4	WR90	1.10	100	FBP100/FBM100/FBE100	Al/Cu
75WTA-90	10.0-15.0	WR75	1.10	90	FBP120/FBM120/FBE120	Al/Cu
62WTA-75	12.4-18.0	WR62	1.10	75	FBP140/FBM140/FBE140	Al/Cu
51WTA-70	15.0-22.0	WR51	1.10	70	FBP180/FBM180/FBE180	Al/Cu
42WTA-60	18.0-26.5	WR42	1.10	60	FBP220/FBM220/FBE220	Al/Cu
34WTA-55	22.0-33.0	WR34	1.10	55	FBP260/FBM260/FBE260	Al/Cu
28WTA-55	26.5-40.0	WR28	1.10	55	FBP320/FBM320/FBE320	Al/Cu
22WTA-50	33.0-50.0	WR22	1.10	50	FUGP400	Cu
19WTA-50	40.0-60.0	WR19	1.10	50	FUGP500	Cu
15WTA-50	50.0-75.0	WR15	1.10	50	FUGP620	Cu
12WTA-50	60.0-90.0	WR12	1.10	50	FUGP740	Cu
10WTA-50	75.0-110.0	WR10	1.10	50	FUGP900	Cu

Ordering Information

P/N:

284 WTA - L
 WR Size Product Code Length (mm)

Example: 284WTA-300 is a WR284 twist waveguide. Length is 300mm.

Note:

1. Customization is available;
2. For detailed information of each twist waveguide, please visit the website: www.ainfoinc.com.

AINFO manufactures wide variety of twist waveguide assemblies specially designed for every customers unique requirements. Twist Waveguide can be assembled with many types of flange. We also offer many other special configurations, length and hole size to meet special requirements.

Double Ridge Twist Waveguide

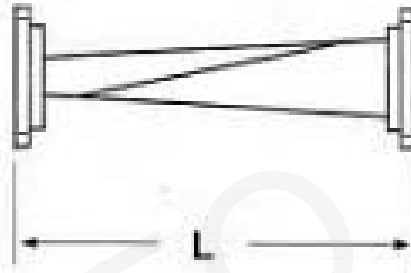

Standard Models				
P/N	Frequency Range (GHz)	Waveguide	VSWR	Length (XXX) (mm)
250DRWTA-XXX	2.6-7.8	WRD250D30	1.25	Customized
350DRWTA-XXX	3.5-8.2	WRD350D24	1.25	Customized
475DRWTA-XXX	4.75-11.0	WRD475D24	1.25	Customized
580DRWTA-XXX	5.8-16.0	WRD580D28	1.25	Customized
650DRWTA-XXX	6.5-18.0	WRD650D28	1.25	Customized
750DRWTA-XXX	7.5-18.0	WRD750D24	1.25	Customized
180DRWTA-XXX	18.0-40.0	WRD180C24	1.25	Customized

Ordering Information	
<p>P/N:</p> <p style="text-align: center;"> <u>250</u> <u>DRWTA</u> - <u>XXX</u> WR Size Product Code Length (mm) </p> <p>Example: 250DRWTA-500 is a WRD250D30 double ridge twist waveguide. Length is 500mm.</p>	<p>AINFO manufactures wide variety of double ridge twist waveguide assemblies specially designed for every customers unique requirements. Double Ridge Twist Waveguide can be assembled with many types of flange. We also offer many other special configurations, length and hole size to meet special requirements.</p>
<p>Note:</p> <p>1. Customization is available;</p> <p>2. For detailed information of each double ridge twist waveguide, please visit the website: www.ainfoinc.com</p>	

Right Angle Waveguide to Coaxial Adapter

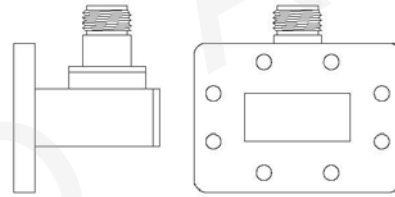

Standard Models

P/N	Frequency Range (GHz)	Waveguide	VSWR	Flange	Connector	Material
975WCAN	0.75-1.12	WR975	1.25	FDP9	N-F	Al
770WCAN	0.96-1.45	WR770	1.25	FDP12	N-F	Al
650WCAN	1.12-1.70	WR650	1.25	FDP14/FDM14	N-F	Al
510WCAN	1.45-2.20	WR510	1.25	FDP18/FDM18	N-F	Al
430WCAN	1.70-2.60	WR430	1.25	FDP22/FDM22	N-F	Al
340WCAN	2.20-3.30	WR340	1.25	FDP26/FDM26	N-F	Al/Cu
284WCAN	2.60-3.95	WR284	1.25	FDP32/FDM32	N-F	Al/Cu
229WCAN	3.30-4.90	WR229	1.25	FDP40/FDM40	N-F	Al/Cu
187WCAN	3.95-5.85	WR187	1.25	FDP48/FDM48	N-F	Al/Cu
159WCAN	4.90-7.05	WR159	1.25	FDP58/FDM58	N-F	Al/Cu
137WCAN	5.85-8.20	WR137	1.25	FDP70/FDM70	N-F	Al/Cu
137WCAS	5.85-8.20	WR137	1.25	FDP70/FDM70	SMA-F	Al/Cu
112WCAN	7.05-10.0	WR112	1.25	FBP84/FBM84/FBE84	N-F	Al/Cu
112WCAS	7.05-10.0	WR112	1.25	FBP84/FBM84/FBE84	SMA-F	Al/Cu
90WCAN	8.20-12.4	WR90	1.25	FBP100/FBM100/FBE100	N-F	Al/Cu
90WCAS	8.20-12.4	WR90	1.25	FBP100/FBM100/FBE100	SMA-F	Al/Cu
75WCAN	10.0-15.0	WR75	1.25	FBP120/FBM120/FBE120	N-F	Al/Cu
75WCAS	10.0-15.0	WR75	1.25	FBP120/FBM120/FBE120	SMA-F	Al/Cu
62WCAS	12.4-18.0	WR62	1.25	FBP140/FBM140/FBE140	SMA-F	Al/Cu
51WCAS	15.0-22.0	WR51	1.25	FBP180/FBM180/FBE180	SMA-F	Al/Cu
42WCAS	18.0-26.5	WR42	1.30	FBP220/FBM220/FBE220	SMA-F	Al/Cu
34WCAS	22.0-33.0	WR34	1.50	FBP260/FBM260/FBE260	SMA-F	Al/Cu
28WCAK	26.5-40.0	WR28	1.50	FBP320/FBM320/FBE320	2.92K-F	Al/Cu
22WCA2.4	33.0-50.0	WR22	1.50	FUGP400	2.4mm-F	Cu
19WCAV	40.0-60.0	WR19	1.50	FUGP500	1.85mm-F	Cu

Ordering Information

P/N:

229

WR Size

WCAN

Product Code

AINFO manufactures wide variety of right angle waveguide to coaxial adapter assemblies specially designed for every customers unique requirements. Right Angle Waveguide to Coaxial Adapter can be assembled with many types of flange. We also offer many other special configurations, length and hole size to meet special requirements.

Example: 229WCAN is a WR229 waveguide to coaxial adapter(N type Female connector).

Note:

1. Customization is available;
2. For detailed information of each right angle waveguide to coaxial adapter, please visit the website: www.ainfoinc.com.

Endlaunch Waveguide to Coaxial Adapter

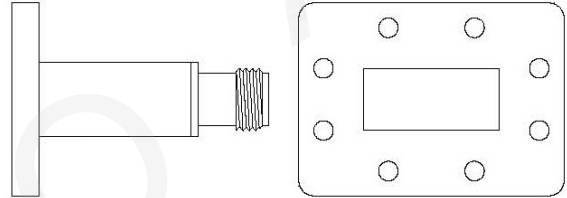

Standard Models						
P/N	Frequency Range (GHz)	Waveguide	VSWR	Flange	Connector	Material
430WECAN	1.70-2.60	WR430	1.25	FDP22/FDM22	N-F	Al
340WECAN	2.20-3.30	WR340	1.25	FDP26/FDM26	N-F	Al/Cu
340WECAS	2.20-3.30	WR340	1.25	FDP26/FDM26	SMA-F	Al/Cu
284WECAN	2.60-3.95	WR284	1.25	FDP32/FDM32	N-F	Al/Cu
284WECAS	2.60-3.95	WR284	1.25	FDP32/FDM32	SMA-F	Al/Cu
229WECAN	3.30-4.90	WR229	1.25	FDP40/FDM40	N-F	Al/Cu
229WECAS	3.30-4.90	WR229	1.25	FDP40/FDM40	SMA-F	Al/Cu
187WECAN	3.95-5.85	WR187	1.25	FDP48/FDM48	N-F	Al/Cu
187WECAS	3.95-5.85	WR187	1.25	FDP48/FDM48	SMA-F	Al/Cu
159WECAN	4.90-7.05	WR159	1.25	FDP58/FDM58	N-F	Al/Cu
159WECAS	4.90-7.05	WR159	1.25	FDP58/FDM58	SMA-F	Al/Cu
137WECAN	5.85-8.20	WR137	1.25	FDP70/FDM70	N-F	Al/Cu
137WECAS	5.85-8.20	WR137	1.25	FDP70/FDM70	SMA-F	Al/Cu
112WECAN	7.05-10.0	WR112	1.25	FBP84/FBM84/FBE84	N-F	Al/Cu
112WECAS	7.05-10.0	WR112	1.25	FBP84/FBM84/FBE84	SMA-F	Al/Cu
90WECAN	8.20-12.4	WR90	1.25	FBP100/FBM100/FBE100	N-F	Al/Cu
90WECAS	8.20-12.4	WR90	1.25	FBP100/FBM100/FBE100	SMA-F	Al/Cu
75WECAN	10.0-15.0	WR75	1.25	FBP120/FBM120/FBE120	N-F	Al/Cu
75WECAS	10.0-15.0	WR75	1.25	FBP120/FBM120/FBE120	SMA-F	Al/Cu
62WECAN	12.4-18.0	WR62	1.25	FBP140/FBM140/FBE140	N-F	Al/Cu
62WECAS	12.4-18.0	WR62	1.25	FBP140/FBM140/FBE140	SMA-F	Al/Cu

P/N	Frequency Range (GHz)	Waveguide	VSWR	Flange	Connector	Material
51WECAS	15.0-22.0	WR51	1.25	FBP180/FBM180/FBE180	SMA-F	Al/Cu
51WECAK	15.0-22.0	WR51	1.25	FBP180/FBM180/FBE180	2.92K-F	Al/Cu
42WECAS	18.0-26.5	WR42	1.50	FBP220/FBM220/FBE220	SMA-F	Al/Cu
42WECAK	18.0-26.5	WR42	1.50	FBP220/FBM220/FBE220	2.92K -F	Al/Cu
34WECAS	22.0-33.0	WR34	1.50	FBP260/FBM260/FBE260	SMA-F	Al/Cu
34WECAK	22.0-33.0	WR34	1.50	FBP260/FBM260/FBE260	2.92K -F	Al/Cu
28WECAK	26.5-40.0	WR28	1.50	FBP320/FBM320/FBE320	2.92K-F	Al/Cu
22WECA2.4	33.0-50.0	WR22	2.00	FUGP400	2.4mm-F	Cu
19WECAV	40.0-60.0	WR19	2.00	FUGP500	1.85mm-F	Cu

Ordering Information

P/N:

187 **WECAN**
 WR Product
 Size Code

Example: 187WECAN is a WR187 endlaunch waveguide to coaxial adapter(N type Female connector).

AINFO manufactures wide variety of endlaunch waveguide to coaxial adapter assemblies specially designed for every customers unique requirements. Endlaunch Waveguide to Coaxial Adapter can be assembled with many types of flange. We also offer many other special configurations, length and hole size to meet special requirements.

Note:

1. Customization is available;
2. For detailed information of each endlaunch waveguide to coaxial adapter, please visit the website: www.ainfoinc.com.

Double Ridge Waveguide to Coaxial Adapter



Standard Models

P/N	Frequency Range (GHz)	Waveguide	VSWR	Connector
250DRWCAN	2.6-7.8	WRD250D30	1.50	N-F/SMA-F
350DRWCAN	3.5-8.2	WRD350D24	1.50	N-F/SMA-F
475DRWCAN	4.75-11.0	WRD475D24	1.50	N-F/SMA-F
580DRWCAS	5.8-16.0	WRD580D28	1.50	N-F/SMA-F
650DRWCAS	6.5-18.0	WRD650D28	1.50	N-F/SMA-F
750DRWCAS	7.5-18.0	WRD750D24	1.60	N-F/SMA-F
110DRWCAK	11.0-26.5	WRD110C24	1.80	2.92K-F
180DRWCAK	18.0-40.0	WRD180C24	1.80	2.92K-F

Ordering Information

P/N:

250 **DRWCAN**
 WR Product
 Size Code

Example: 250DRWCAN is a WRD250D30 double ridge waveguide to coaxial adapter(N type Female connector).

AINFO manufactures wide variety of double ridge waveguide to coaxial adapter assemblies specially designed for every customers unique requirements.
 Double Ridge Waveguide to Coaxial Adapter can be assembled with many types of flange. We also offer many other special configurations, length and hole size to meet special requirements.

Note:

1. Customization is available;
2. For detailed information of each double ridge waveguide to coaxial adapter, please visit the website: www.ainfoinc.com.

High Power Double Ridge Waveguide to Coaxial Adapter



Standard Models					
P/N	Frequency Range (GHz)	Waveguide	VSWR	Connector	Average Power (W)
250DRWHPCAN	2.6-7.8	WRD250D30	1.50	N-F	10-300
350DRWHPCAN	3.5-8.2	WRD350D24	1.50	N-F	10-300
475DRWHPCAN	4.75-11.0	WRD475D24	1.50	N-F	10-300
580DRWHPCAS	5.8-16.0	WRD580D28	1.50	SMA-F	10-100
650DRWHPCAS	6.5-18.0	WRD650D28	1.50	SMA-F	10-100
750DRWHPCAS	7.5-18.0	WRD750D24	1.60	SMA-F	10-100
110DRWHPCA	11.0-26.5	WRD110C24	1.80	2.92K-F	10-30
180DRWHPCA	18.0-40.0	WRD180C24	2.0	2.92K-F	10-30

Ordering Information

P/N:

350 **DRWHPCAN**
 WR Size Product Code

Example: 350DRWHPCAN is a WRD350D24 high power double ridge waveguide to coaxial adapter(N type Female connector).

Note:

1. Customization is available;
2. For detailed information of each high power double ridge waveguide to coaxial adapter, please visit the website: www.ainfoinc.com.

AINFO manufactures wide variety of high power double ridge waveguide to coaxial adapter assemblies specially designed for every customers unique requirements. High Power Double Ridge Waveguide to Coaxial Adapter can be assembled with many types of flange. We also offer many other special configurations, length and hole size to meet special requirements.

Waveguide Transition

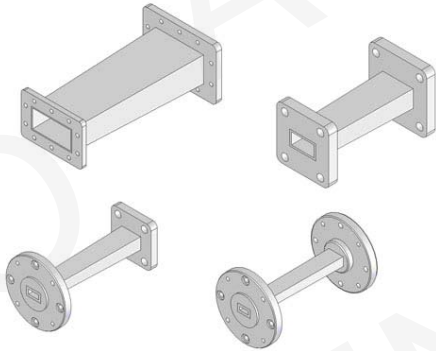

Standard Models

P/N	Frequency Range (GHz)	Waveguide	VSWR	Insertion Loss (dB)	Flange
340284WA-200	2.60-3.30	WR340 to WR284	1.10	0.2	WR340: FDP26/FDM26 WR284: FDP32/FDM32
284229WA-200	3.30-3.95	WR284 to WR229	1.10	0.2	WR284: FDP32/FDM32 WR229:FDP40/FDM40
229187WA-180	3.95-4.90	WR229 to WR187	1.10	0.2	WR229:FDP40/FDM40 WR187:FDP48/FDP48
187159WA-180	4.90-5.85	WR187 to WR159	1.10	0.2	WR187:FDP48/FDP48 WR159:FDP58/FDM58
159137WA-150	5.85-7.05	WR159 to WR137	1.10	0.2	WR159:FDP58/FDM58 WR137:FDP70/FDM70
137112WA-130	7.05-8.20	WR137 to WR112	1.10	0.2	WR137:FDP70/FDM70 WR112: FDP84/FDM84
11290WA-100	8.20-10.0	WR112 to WR90	1.10	0.2	WR112:FBP84/FBM84/FBE84 WR90:FBP100/FBM100/FBE100
9075WA-80	10.0-12.4	WR90 to WR75	1.10	0.2	WR90:FBP100/FBM100/FBE100 WR75:FBP120/FBM120/FBE120
7562WA-75	12.4-15.0	WR75 to WR62	1.10	0.2	WR75:FBP120/FBM120/FBE120 WR62:FBP140/FBM140/FBE140
6251WA-60	15.0-18.0	WR62 to WR51	1.10	0.2	WR62:FBP140/FBM140/FBE140 WR51:FBP180/FBM180/FBE180
5142WA-50	18.0-22.0	WR51 to WR42	1.10	0.2	WR51:FBP180/FBM180/FBE180 WR42:FBP220/FBM220/FBE220
4234WA-50	22.0-26.5	WR42 to WR34	1.10	0.2	WR42:FBP220/FBM220/FBE220 WR34:FBP260/FBM260/FBE260

P/N	Frequency Range (GHz)	Waveguide	VSWR	Insertion Loss (dB)	Flange
3428WA-50	26.5-33.0	WR34 to WR28	1.10	0.2	WR34:FBP260/FBM260/FBE260 WR28:FBP320/FBM320/FBE320
2822WA-50	33.0-40.0	WR28 to WR22	1.10	0.2	WR28:FBP320/FBM320/FBE320 WR22: FUGP400
2219WA-50	40.0-50.0	WR22 to WR19	1.10	0.2	WR22:FUGP400 WR19:FUGP500
1915WA-50	50.0-60.0	WR19 to WR15	1.10	0.2	WR19:FUGP500 WR15:FUGP620
1512WA-50	60.0-75.0	WR15 to WR12	1.10	0.2	WR15:FUGP620 WR12:FUGP740
1210WA-50	75.0-90.0	WR12 to WR10	1.10	0.2	WR12:FUGP740 WR10:FUGP900

Ordering Information

P/N:

229

WR Size

187

WR Size

WA

Product Code

-

L

Length (mm)

Example: 229187WA-180 is a WR229 to WR187 waveguide transition. Length is 180mm.

AINFO manufactures wide variety of waveguide transition assemblies specially designed for every customers unique requirements.

Waveguide Transition can be assembled with many types of flange. We also offer many other special configurations, length and hole size to meet special requirements.

Note:

1. Customization is available;
2. For detailed information of each waveguide transition, please visit the website: www.ainfoinc.com

Waveguide Cross Coupler(W+C-XX Type)

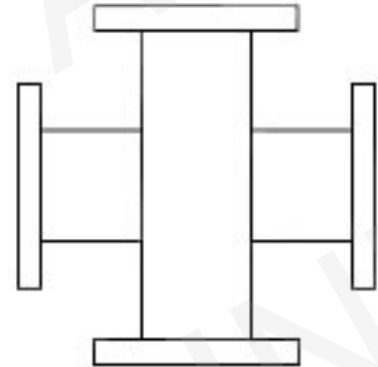
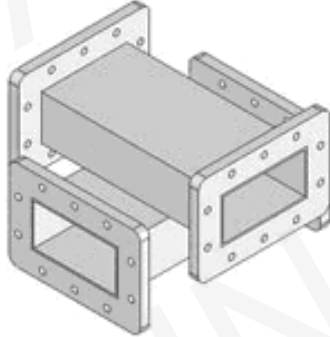

Standard Models									
P/N	Frequency Range (GHz)	Waveguide	Band Width	Coupling (dB)	Directivity (dB) Min.	VSWR Mainline	VSWR Secondline	Flange	Material
975W+C-XX	0.75-1.12	WR975	10%-20%	20/30 /40/50	18	1.15	1.25	FDP9	Al
770W+C-XX	0.96-1.45	WR770	10%-20%	20/30 /40/50	18	1.15	1.25	FDP12	Al
650W+C-XX	1.12-1.70	WR650	10%-20%	20/30 /40/50	18	1.15	1.25	FDP14/ FDM14	Al
510W+C-XX	1.45-2.20	WR510	10%-20%	20/30 /40/50	18	1.15	1.25	FDP18/ FDM18	Al/Cu
430W+C-XX	1.70-2.60	WR430	10%-20%	20/30 /40/50	18	1.15	1.25	FDP22/ FDM22	Al/Cu
340W+C-XX	2.20-3.30	WR340	10%-20%	20/30 /40/50	18	1.15	1.25	FDP26/ FDM26	Al/Cu
284W+C-XX	2.60-3.95	WR284	10%-20%	20/30 /40/50	18	1.15	1.25	FDP32/ FDM32	Al/Cu
229W+C-XX	3.30-4.90	WR229	10%-20%	20/30 /40/50	18	1.15	1.25	FDP40/ FDM40	Al/Cu
187W+C-XX	3.95-5.85	WR187	10%-20%	20/30 /40/50	18	1.15	1.25	FDP48/ FDM48	Al/Cu
159W+C-XX	4.90-7.05	WR159	10%-20%	20/30 /40/50	18	1.15	1.25	FDP58/ FDM58	Al/Cu
137W+C-XX	5.85-8.20	WR137	10%-20%	20/30 /40/50	18	1.15	1.25	FDP70/ FDM70	Al/Cu
112W+C-XX	7.05-10.0	WR112	10%-20%	20/30 /40/50	18	1.15	1.25	FBP84/ FBM84/ FBE84	Al/Cu
90W+C-XX	8.20-12.4	WR90	10%-20%	20/30 /40/50	18	1.15	1.25	FBP100/ FBM100/ FBE100	Al/Cu
75W+C-XX	10.0-15.0	WR75	10%-20%	20/30 /40/50	18	1.15	1.25	FBP120/ FBM120/ FBE120	Al/Cu

P/N	Frequency Range (GHz)	Waveguide	Band Width	Coupling (dB)	Directivity (dB) Min.	VSWR Mainline	VSWR Secondline	Flange	Material
62W+C-XX	12.4-18.0	WR62	10%-20%	20/30 /40/50	18	1.15	1.25	FBP140/ FBM140/ FBE140	Al/Cu
51W+C-XX	15.0-22.0	WR51	10%-20%	20/30 /40/50	18	1.15	1.25	FBP180/ FBM180/ FBE180	Al/Cu
42W+C-XX	18.0-26.5	WR42	10%-20%	20/30 /40/50	18	1.15	1.25	FBP220/ FBM220/ FBE220	Al/Cu
34W+C-XX	22.0-33.0	WR34	10%-20%	20/30 /40/50	18	1.15	1.25	FBP260/ FBM260/ FBE260	Al/Cu
28W+C-XX	26.5-40.0	WR28	10%-20%	20/30 /40/50	18	1.20	1.25	FBP320/ FBM320/ FBE320	Al/Cu

Ordering Information

P/N:

187 W+C - XX
 WR Size Product Code Coupling (dB)

Example: 187W+C-20 is a WR187 waveguide cross coupler. Coupling is 20dB.

AINFO manufactures wide variety of waveguide cross coupler assemblies specially designed for every customers unique requirements. Waveguide Cross Coupler can be assembled with many types of flange. We also offer many other special configurations, length and hole size to meet special requirements.

Note:

1. Customization is available;
2. For detailed information of each W+C-XX type waveguide cross coupler, please visit the website: www.ainfoinc.com.

Waveguide Cross Coupler(WL+C-XX Type)

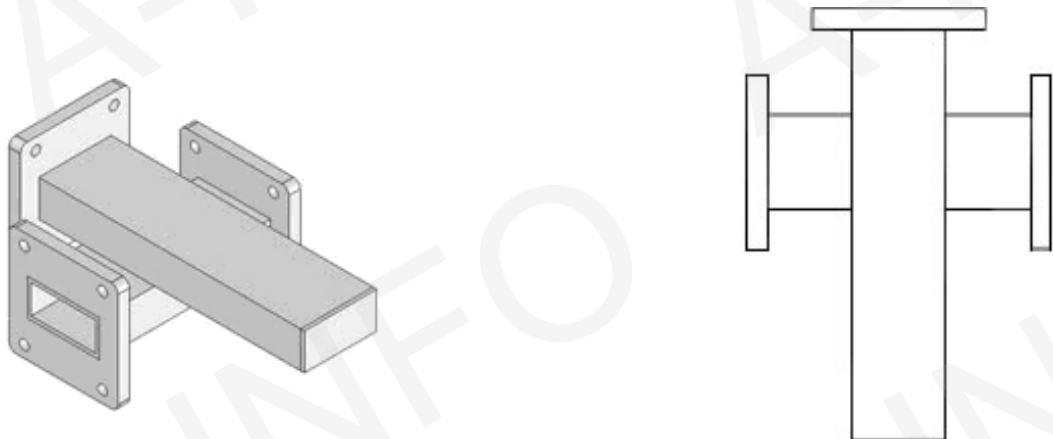

Standard Models									
P/N	Frequency Range (GHz)	Waveguide	Band Width	Coupling (dB)	Directivity (dB) Min.	VSWR Mainline	VSWR Secondline	Flange	Material
975WL+C-XX	0.75-1.12	WR975	10%-20%	20/30 /40/50	18	1.15	1.25	FDP9	Al
770WL+C-XX	0.96-1.45	WR770	10%-20%	20/30 /40/50	18	1.15	1.25	FDP12	Al
650WL+C-XX	1.12-1.70	WR650	10%-20%	20/30 /40/50	18	1.15	1.25	FDP14/ FDM14	Al
510WL+C-XX	1.45-2.20	WR510	10%-20%	20/30 /40/50	18	1.15	1.25	FDP18/ FDM18	Al/Cu
430WL+C-XX	1.70-2.60	WR430	10%-20%	20/30 /40/50	18	1.15	1.25	FDP22/ FDM22	Al/Cu
340WL+C-XX	2.20-3.30	WR340	10%-20%	20/30 /40/50	18	1.15	1.25	FDP26/ FDM26	Al/Cu
284WL+C-XX	2.60-3.95	WR284	10%-20%	20/30 /40/50	18	1.15	1.25	FDP32/ FDM32	Al/Cu
229WL+C-XX	3.30-4.90	WR229	10%-20%	20/30 /40/50	18	1.15	1.25	FDP40/ FDM40	Al/Cu
187WL+C-XX	3.95-5.85	WR187	10%-20%	20/30 /40/50	18	1.15	1.25	FDP48/ FDM48	Al/Cu
159WL+C-XX	4.90-7.05	WR159	10%-20%	20/30 /40/50	18	1.15	1.25	FDP58/ FDM58	Al/Cu
137WL+C-XX	5.85-8.20	WR137	10%-20%	20/30 /40/50	18	1.15	1.25	FDP70/ FDM70	Al/Cu
112WL+C-XX	7.05-10.0	WR112	10%-20%	20/30 /40/50	18	1.15	1.25	FBP84/ FBM84/ FBE84	Al/Cu
90WL+C-XX	8.20-12.4	WR90	10%-20%	20/30 /40/50	18	1.15	1.25	FBP100/ FBM100/ FBE100	Al/Cu
75WL+C-XX	10.0-15.0	WR75	10%-20%	20/30 /40/50	18	1.15	1.25	FBP120/ FBM120/ FBE120	Al/Cu

P/N	Frequency Range (GHz)	Waveguide	Band Width	Coupling (dB)	Directivity (dB) Min.	VSWR Mainline	VSWR Secondline	Flange	Material
62WL+C-XX	12.4-18.0	WR62	10%-20%	20/30 /40/50	18	1.15	1.25	FBP140/ FBM140/ FBE140	Al/Cu
51WL+C-XX	15.0-22.0	WR51	10%-20%	20/30 /40/50	18	1.15	1.25	FBP180/ FBM180/ FBE180	Al/Cu
42WL+C-XX	18.0-26.5	WR42	10%-20%	20/30 /40/50	18	1.15	1.25	FBP220/ FBM220/ FBE220	Al/Cu
34WL+C-XX	22.0-33.0	WR34	10%-20%	20/30 /40/50	18	1.15	1.25	FBP260/ FBM260/ FBE260	Al/Cu
28WL+C-XX	26.5-40.0	WR28	10%-20%	20/30 /40/50	18	1.20	1.25	FBP320/ FBM320/ FBE320	Al/Cu

Ordering Information

P/N:

159 **WL+C** - **XX**
 WR Size Product Code Coupling (dB)

Example: 159WL+C-20 is a WR159 waveguide cross coupler. Coupling is 20dB.

AINFO manufactures wide variety of waveguide cross coupler assemblies specially designed for every customers unique requirements.

Waveguide Cross Coupler can be assembled with many types of flange. We also offer many other special configurations, length and hole size to meet special requirements.

Note:

1. Customization is available;
2. For detailed information of each WL+C-XX type waveguide cross coupler, please visit the website: www.ainfoinc.com.

Waveguide Cross Coupler(WL+CN-XX Type)

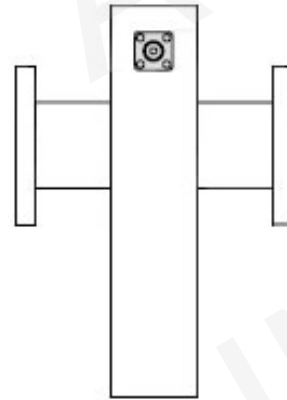
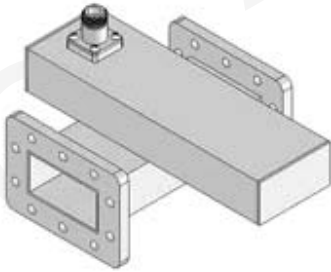

Standard Models

P/N	Frequency Range (GHz)	Waveguide	Band Width	Coupling (dB)	Directivity (dB) Min.	VSWR Mainline	VSWR Secondline	Flange	Material
975WL+CN-XX	0.75-1.12	WR975	10%-20%	20/30 /40/50	18	1.15	1.25	FDP9	Al
770WL+CN-XX	0.96-1.45	WR770	10%-20%	20/30 /40/50	18	1.15	1.25	FDP12	Al
650WL+CN-XX	1.12-1.70	WR650	10%-20%	20/30 /40/50	18	1.15	1.25	FDP14/ FDM14	Al
510WL+CN-XX	1.45-2.20	WR510	10%-20%	20/30 /40/50	18	1.15	1.25	FDP18/ FDM18	Al/Cu
430WL+CN-XX	1.70-2.60	WR430	10%-20%	20/30 /40/50	18	1.15	1.25	FDP22/ FDM22	Al/Cu
340WL+CN-XX	2.20-3.30	WR340	10%-20%	20/30 /40/50	18	1.15	1.25	FDP26/ FDM26	Al/Cu
284WL+CN-XX	2.60-3.95	WR284	10%-20%	20/30 /40/50	18	1.15	1.25	FDP32/ FDM32	Al/Cu
229WL+CN-XX	3.30-4.90	WR229	10%-20%	20/30 /40/50	18	1.15	1.25	FDP40/ FDM40	Al/Cu
187WL+CN-XX	3.95-5.85	WR187	10%-20%	20/30 /40/50	18	1.15	1.25	FDP48/ FDM48	Al/Cu
159WL+CN-XX	4.90-7.05	WR159	10%-20%	20/30 /40/50	18	1.15	1.25	FDP58/ FDM58	Al/Cu
137WL+CN-XX	5.85-8.20	WR137	10%-20%	20/30 /40/50	18	1.15	1.25	FDP70/ FDM70	Al/Cu
112WL+CN-XX	7.05-10.0	WR112	10%-20%	20/30 /40/50	18	1.15	1.25	FBP84/ FBM84/ FBE84	Al/Cu
90WL+CN-XX	8.20-12.4	WR90	10%-20%	20/30 /40/50	18	1.15	1.25	FBP100/ FBM100/ FBE100	Al/Cu
75WL+CS-XX	10.0-15.0	WR75	10%-20%	20/30 /40/50	18	1.15	1.25	FBP120/ FBM120/ FBE120	Al/Cu

P/N	Frequency Range (GHz)	Waveguide	Band Width	Coupling (dB)	Directivity (dB) Min.	VSWR Mainline	VSWR Secondline	Flange	Material
62WL+CS - XX	12.4-18.0	WR62	10%-20%	20/30 /40/50	18	1.15	1.25	FBP140/ FBM140/ FBE140	Al/Cu
51WL+CS - XX	15.0-22.0	WR51	10%-20%	20/30 /40/50	18	1.15	1.25	FBP180/ FBM180/ FBE180	Al/Cu
42WL+CS - XX	18.0-26.5	WR42	10%-20%	20/30 /40/50	18	1.15	1.25	FBP220/ FBM220/ FBE220	Al/Cu
34WL+CS - XX	22.0-33.0	WR34	10%-20%	20/30 /40/50	18	1.15	1.25	FBP260/ FBM260/ FBE260	Al/Cu
28WL+CS - XX	26.5-40.0	WR28	10%-20%	20/30 /40/50	18	1.20	1.25	FBP320/ FBM320/ FBE320	Al/Cu

Ordering Information

P/N:

137 **WL+CN** - **XX**
 WR Size Product Code Coupling (dB)

Example: 137WL+CN -20 is a WR137 waveguide cross coupler(N type Female connector). Coupling is 20dB.

AINFO manufactures wide variety of waveguide cross coupler assemblies specially designed for every customers unique requirements. Waveguide Cross Coupler can be assembled with many types of flange. We also offer many other special configurations, length and hole size to meet special requirements.

Note:

1. Customization is available;
2. For detailed information of each WL+CN-XX type waveguide cross coupler, please visit the website: www.ainfoinc.com.

Waveguide High Directional Coupler (WC-XX Type)

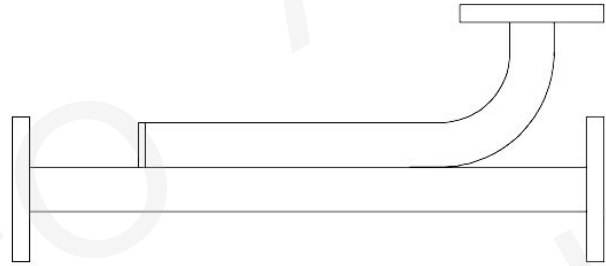

Standard Models										
P/N	Frequency Range (GHz)	Frequency Sensitivity (dB)	Waveguide	Coupling (dB)	Coupling Accuracy (dB)	Directivity (dB) Min.	VSWR Mainline	VSWR Secondline	Flange	Material
284WC-XX	2.60-3.95	±0.7	WR284	3/6/ 10/20/30	±0.7	30	1.10	1.25	FDP32/ FDM32	Al/Cu
229WC-XX	3.30-4.90	±0.7	WR229	3/6/ 10/20/30	±0.7	30	1.10	1.25	FDP40/ FDM40	Al/Cu
187WC-XX	3.95-5.85	±0.7	WR187	3/6/ 10/20/30	±0.7	30	1.10	1.25	FDP48/ FDM48	Al/Cu
159WC-XX	4.90-7.05	±0.7	WR159	3/6/ 10/20/30	±0.7	30	1.10	1.25	FDP58/ FDM58	Al/Cu
137WC-XX	5.85-8.20	±0.7	WR137	3/6/ 10/20/30	±0.7	30	1.10	1.25	FDP70/ FDM70	Al/Cu
112WC-XX	7.05-10.0	±0.7	WR112	3/6/ 10/20/30	±0.7	30	1.10	1.25	FBP84/ FBM84/ FBE84	Al/Cu
90WC-XX	8.20-12.4	±0.7	WR90	3/6/ 10/20/30	±0.7	30	1.10	1.25	FBP100/ FBM100/ FBE100	Al/Cu
75WC-XX	10.0-15.0	±0.7	WR75	3/6/ 10/20/30	±0.7	30	1.10	1.25	FBP120/ FBM120/ FBE120	Al/Cu
62WC-XX	12.4-18.0	±0.7	WR62	3/6/ 10/20/30	±0.7	30	1.10	1.25	FBP140/ FBM140/ FBE140	Al/Cu
51WC-XX	15.0-22.0	±0.7	WR51	3/6/ 10/20/30	±0.7	30	1.10	1.25	FBP180/ FBM180/ FBE180	Al/Cu
42WC-XX	18.0-26.5	±0.9	WR42	3/6/ 10/20/30	±1.0	30	1.15	1.30	FBP220/ FBM220/ FBE220	Al/Cu

P/N	Frequency Range (GHz)	Frequency Sensitivity (dB)	Waveguide	Coupling (dB)	Coupling Accuracy (dB)	Directivity (dB) Min.	VSWR Mainline	VSWR Secondline	Flange	Material
34WC-XX	22.0-33.0	±0.9	WR34	3/6/ 10/20/30	±1.0	30	1.15	1.50	FBP260/ FBM260/ FBE260	Al/Cu
28WC-XX	26.5-40.0	±0.9	WR28	3/6/ 10/20/30	±1.0	30	1.15	1.50	FBP320/ FBM320/ FBE320	Al/Cu
22WC-XX	33.0-50.0	±0.9	WR22	10/20/30	±1.3	20	1.15	1.50	FUGP400	Cu
19WC-XX	40.0-60.0	±0.9	WR19	10/20/30	±1.3	20	1.15	1.50	FUGP500	Cu
15WC-XX	50.0-75.0	±0.9	WR15	10/20/30	±1.3	20	1.20	1.50	FUGP620	Cu
12WC-XX	60.0-90.0	±0.9	WR12	10/20/30	±1.3	20	1.20	1.50	FUGP740	Cu
10WC-XX	75.0-110.0	±0.9	WR10	10/20/30	±1.3	20	1.20	1.50	FUGP900	Cu

Ordering Information

P/N:

112 **WC** - **XX**
 WR Size Product Code Coupling (dB)

Example: 112WC-10 is a WR112 high directional coupler. Coupling is 10dB.

AINFO manufactures wide variety of waveguide high directional coupler assemblies specially designed for every customers unique requirements. Waveguide High Directional Coupler can be assembled with many types of flange. We also offer many other special configurations, length and hole size to meet special requirements.

Note:

1. Customization is available;
2. For detailed information of each WC-XX type high directional coupler, please visit the website: www.ainfoinc.com

Waveguide High Directional Coupler(WCN-XX Type)

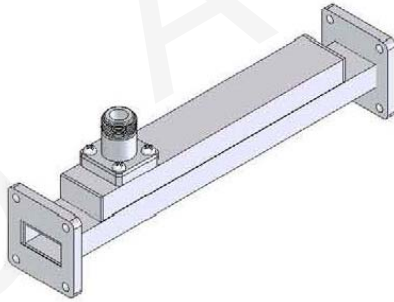

Standard Models

P/N	Frequency Range (GHz)	Frequency Sensitivity (dB)	Waveguide	Coupling (dB)	Coupling Accuracy (dB)	Directivity (dB) Min.	VSWR Mainline	VSWR Secondline	Flange	Material
430WCN-XX	1.70-2.60	±0.7	WR430	10/20/30	±0.9	30	1.10	1.25	FDP22/ FDM22	Al/Cu
340WCN-XX	2.20-3.30	±0.7	WR340	10/20/30	±0.9	30	1.10	1.25	FDP26/ FDM26	Al/Cu
284WCN-XX	2.60-3.95	±0.7	WR284	3/6/ 10/20/30	±0.7	30	1.10	1.25	FDP32/ FDM32	Al/Cu
229WCN-XX	3.30-4.90	±0.7	WR229	3/6/ 10/20/30	±0.7	30	1.10	1.25	FDP40/ FDM40	Al/Cu
187WCN-XX	3.95-5.85	±0.7	WR187	3/6/ 10/20/30	±0.7	30	1.10	1.25	FDP48/ FDM48	Al/Cu
159WCN-XX	4.90-7.05	±0.7	WR159	3/6/ 10/20/30	±0.7	30	1.10	1.25	FDP58/ FDM58	Al/Cu
137WCN-XX	5.85-8.20	±0.7	WR137	3/6/ 10/20/30	±0.7	30	1.10	1.25	FDP70/ FDM70	Al/Cu
112WCN-XX	7.05-10.0	±0.7	WR112	3/6/ 10/20/30	±0.7	30	1.10	1.25	FBP84/ FBM84/ FBE84	Al/Cu
90WCN-XX	8.20-12.4	±0.7	WR90	3/6/ 10/20/30	±0.7	30	1.10	1.25	FBP100/ FBM100/ FBE100	Al/Cu
75WCS-XX	10.0-15.0	±0.7	WR75	3/6/ 10/20/30	±0.7	30	1.10	1.25	FBP120/ FBM120/ FBE120	Al/Cu
62WCS-XX	12.4-18.0	±0.7	WR62	3/6/ 10/20/30	±0.7	30	1.10	1.25	FBP140/ FBM140/ FBE140	Al/Cu

P/N	Frequency Range (GHz)	Frequency Sensitivity (dB)	Waveguide	Coupling (dB)	Coupling Accuracy (dB)	Directivity (dB) Min.	VSWR Mainline	VSWR Secondline	Flange	Material
51WCS-XX	15.0-22.0	±0.7	WR51	3/6/10/20/30	±0.7	30	1.10	1.25	FBP180/ FBM180/ FBE180	Al/Cu
42WCS-XX	18.0-26.5	±0.9	WR42	3/6/10/20/30	±1.0	30	1.15	1.30	FBP220/ FBM220/ FBE220	Al/Cu
34WCS-XX	22.0-33.0	±0.9	WR34	3/6/10/20/30	±1.0	30	1.15	1.50	FBP260/ FBM260/ FBE260	Al/Cu
28WCS-XX	26.5-40.0	±0.9	WR28	3/6/10/20/30	±1.0	30	1.15	1.50	FBP320/ FBM320/ FBE320	Al/Cu

Ordering Information

P/N:

90 WCN - XX
 WR Size Product Code Coupling (dB)

Example: 90WCN-10 is a WR90 high directional coupler. Coupling is 10dB, N type Female connector.

AINFO manufactures wide variety of waveguide high directional coupler assemblies specially designed for every customers unique requirements. Waveguide High Directional Coupler can be assembled with many types of flange. We also offer many other special configurations, length and hole size to meet special requirements.

Note:

1. Customization is available;
2. For detailed information of each WCN-XX type high directional coupler, please visit the website: www.ainfoinc.com

Waveguide High Directional Coupler (WIC-XX Type)

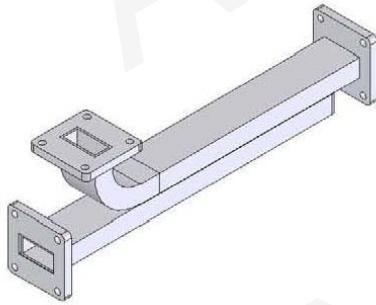

Standard Models										
P/N	Frequency Range (GHz)	Frequency Sensitivity (dB)	Waveguide	Coupling (dB)	Coupling Accuracy (dB)	Directivity (dB) Min.	VSWR Mainline	VSWR Secondline	Flange	Material
284WIC-XX	2.60-3.95	±0.7	WR284	3/6/10 /20/30	±0.7	30	1.10	1.25	FDP32/ FDM32	Al/Cu
229WIC-XX	3.30-4.90	±0.7	WR229	3/6/10 /20/30	±0.7	30	1.10	1.25	FDP40/ FDM40	Al/Cu
187WIC-XX	3.95-5.85	±0.7	WR187	3/6/10 /20/30	±0.7	30	1.10	1.25	FDP48/ FDM48	Al/Cu
159WIC-XX	4.90-7.05	±0.7	WR159	3/6/10 /20/30	±0.7	30	1.10	1.25	FDP58/ FDM58	Al/Cu
137WIC-XX	5.85-8.20	±0.7	WR137	3/6/10 /20/30	±0.7	30	1.10	1.25	FDP70/ FDM70	Al/Cu
112WIC-XX	7.05-10.0	±0.7	WR112	3/6/10 /20/30	±0.7	30	1.10	1.25	FBP84/ FBM84/ FBE84	Al/Cu
90WIC-XX	8.20-12.4	±0.7	WR90	3/6/10 /20/30	±0.7	30	1.10	1.25	FBP100/ FBM100/ FBE100	Al/Cu
75WIC-XX	10.0-15.0	±0.7	WR75	3/6/10 /20/30	±0.7	30	1.10	1.25	FBP120/ FBM120/ FBE120	Al/Cu
62WIC-XX	12.4-18.0	±0.7	WR62	3/6/10 /20/30	±0.7	30	1.10	1.25	FBP140/ FBM140/ FBE140	Al/Cu
51WIC-XX	15.0-22.0	±0.7	WR51	3/6/10 /20/30	±0.7	30	1.10	1.25	FBP180/ FBM180/ FBE180	Al/Cu
42WIC-XX	18.0-26.5	±0.9	WR42	3/6/10 /20/30	±1.0	30	1.15	1.30	FBP220/ FBM220/ FBE220	Al/Cu

P/N	Frequency Range (GHz)	Frequency Sensitivity (dB)	Waveguide	Coupling (dB)	Coupling Accuracy (dB)	Directivity (dB) Min.	VSWR Mainline	VSWR Secondline	Flange	Material
34WIC-XX	22.0-33.0	±0.9	WR34	3/6/10 /20/30	±1.0	30	1.15	1.50	FBP260/ FBM260/ FBE260	Al/Cu
28WIC-XX	26.5-40.0	±0.9	WR28	3/6/10 /20/30	±1.0	30	1.15	1.50	FBP320/ FBM320/ FBE320	Al/Cu

Ordering Information

P/N:

75 **WIC** - **XX**
 WR Size Product Code Coupling (dB)

Example: 75WIC-10 is a WR75 high directional coupler. Coupling is 10dB.

AINFO manufactures wide variety of waveguide high directional coupler assemblies specially designed for every customers unique requirements. Waveguide High Directional Coupler can be assembled with many types of flange. We also offer many other special configurations, length and hole size to meet special requirements.

Note:

1. Customization is available;
2. For detailed information of each WIC-XX type high directional coupler, please visit the website: www.ainfoinc.com

Waveguide High Directional Coupler (WYC-XX Type)

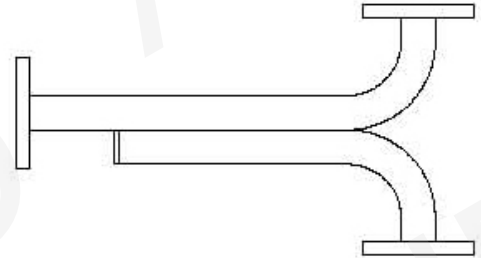
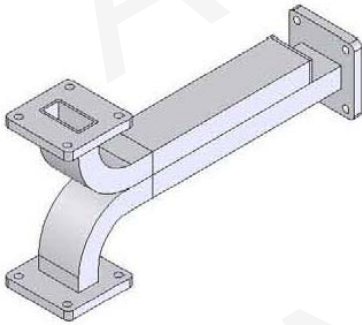

Standard Models

P/N	Frequency Range (GHz)	Frequency Sensitivity (dB)	Waveguide	Coupling (dB)	Coupling Accuracy (dB)	Directivity (dB) Min.	VSWR Mainline	VSWR Secondline	Flange	Material
284WYC-XX	2.60-3.95	±0.7	WR284	3/6/10 /20/30	±0.7	30	1.10	1.25	FDP32/ FDM32	Al/Cu
229WYC-XX	3.30-4.90	±0.7	WR229	3/6/10 /20/30	±0.7	30	1.10	1.25	FDP40/ FDM40	Al/Cu
187WYC-XX	3.95-5.85	±0.7	WR187	3/6/10 /20/30	±0.7	30	1.10	1.25	FDP48/ FDM48	Al/Cu
159WYC-XX	4.90-7.05	±0.7	WR159	3/6/10 /20/30	±0.7	30	1.10	1.25	FDP58/ FDM58	Al/Cu
137WYC-XX	5.85-8.20	±0.7	WR137	3/6/10 /20/30	±0.7	30	1.10	1.25	FDP70/ FDM70	Al/Cu
112WYC-XX	7.05-10.0	±0.7	WR112	3/6/10 /20/30	±0.7	30	1.10	1.25	FBP84/ FBM84/ FBE84	Al/Cu
90WYC-XX	8.20-12.4	±0.7	WR90	3/6/10 /20/30	±0.7	30	1.10	1.25	FBP100/ FBM100/ FBE100	Al/Cu
75WYC-XX	10.0-15.0	±0.7	WR75	3/6/10 /20/30	±0.7	30	1.10	1.25	FBP120/ FBM120/ FBE120	Al/Cu
62WYC-XX	12.4-18.0	±0.7	WR62	3/6/10 /20/30	±0.7	30	1.10	1.25	FBP140/ FBM140/ FBE140	Al/Cu
51WYC-XX	15.0-22.0	±0.7	WR51	3/6/10 /20/30	±0.7	30	1.10	1.25	FBP180/ FBM180/ FBE180	Al/Cu
42WYC-XX	18.0-26.5	±0.9	WR42	3/6/10 /20/30	±1.0	30	1.15	1.30	FBP220/ FBM220/ FBE220	Al/Cu

P/N	Frequency Range (GHz)	Frequency Sensitivity (dB)	Waveguide	Coupling (dB)	Coupling Accuracy (dB)	Directivity (dB) Min.	VSWR Mainline	VSWR Secondline	Flange	Material
34WYC-XX	22.0-33.0	±0.9	WR34	3/6/10 /20/30	±1.0	30	1.15	1.50	FBP260/ FBM260/ FBE260	Al/Cu
28WYC-XX	26.5-40.0	±0.9	WR28	3/6/10 /20/30	±1.0	30	1.15	1.50	FBP320/ FBM320/ FBE320	Al/Cu

Ordering Information

P/N:

62 **WYC** - **XX**
 WR Size Product Code Coupling (dB)

Example: 62WYC-10 is a WR62 high directional coupler. Coupling is 10dB.

AINFO manufactures wide variety of waveguide high directional coupler assemblies specially designed for every customers unique requirements. Waveguide High Directional Coupler can be assembled with many types of flange. We also offer many other special configurations, length and hole size to meet special requirements.

Note:

1. Customization is available;
2. For detailed information of each WYC-XX type high directional coupler, please visit the website: www.ainfoinc.com

Waveguide High Directional Coupler (WICN-XX Type)

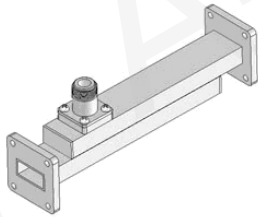

Standard Models

P/N	Frequency Range (GHz)	Frequency Sensitivity (dB)	Waveguide	Coupling (dB)	Coupling Accuracy (dB)	Directivity (dB) Min.	VSWR Mainline	VSWR Secondline	Flange	Material
284WICN-XX	2.60-3.95	±0.7	WR284	3/6/ 10/20/30	±0.7	30	1.10	1.25	FDP32/ FDM32	Al/Cu
229WICN-XX	3.30-4.90	±0.7	WR229	3/6/ 10/20/30	±0.7	30	1.10	1.25	FDP40/ FDM40	Al/Cu
187WICN-XX	3.95-5.85	±0.7	WR187	3/6/ 10/20/30	±0.7	30	1.10	1.25	FDP48/ FDM48	Al/Cu
159WICN-XX	4.90-7.05	±0.7	WR159	3/6/ 10/20/30	±0.7	30	1.10	1.25	FDP58/ FDM58	Al/Cu
137WICN-XX	5.85-8.20	±0.7	WR137	3/6/ 10/20/30	±0.7	30	1.10	1.25	FDP70/ FDM70	Al/Cu
112WICN-XX	7.05-10.0	±0.7	WR112	3/6/ 10/20/30	±0.7	30	1.10	1.25	FBP84/ FBM84/ FBE84	Al/Cu
90WICN-XX	8.20-12.4	±0.7	WR90	3/6/ 10/20/30	±0.7	30	1.10	1.25	FBP100/ FBM100/ FBE100	Al/Cu
75WICS-XX	10.0-15.0	±0.7	WR75	3/6/ 10/20/30	±0.7	30	1.10	1.25	FBP120/ FBM120/ FBE120	Al/Cu
62WICS-XX	12.4-18.0	±0.7	WR62	3/6/ 10/20/30	±0.7	30	1.10	1.25	FBP140/ FBM140/ FBE140	Al/Cu
51WICS-XX	15.0-22.0	±0.7	WR51	3/6/ 10/20/30	±0.7	30	1.10	1.25	FBP180/ FBM180/ FBE180	Al/Cu
42WICS-XX	18.0-26.5	±0.9	WR42	3/6/ 10/20/30	±1.0	30	1.15	1.30	FBP220/ FBM220/ FBE220	Al/Cu
34WICS-XX	22.0-33.0	±0.9	WR34	3/6/ 10/20/30	±1.0	30	1.15	1.50	FBP260/ FBM260/ FBE260	Al/Cu
28WICS-XX	26.5-40.0	±0.9	WR28	3/6/ 10/20/30	±1.0	30	1.15	1.50	FBP320/ FBM320/ FBE320	Al/Cu

Ordering Information

P/N:

62 **WICS** - **XX**
 WR Size Product Code Coupling (dB)

Example: 62WICS-10 is a WR62 high directional coupler(SMA Female connector). Coupling is 10dB.

AINFO manufactures wide variety of waveguide high directional coupler assemblies specially designed for every customers unique requirements. Waveguide High Directional Coupler can be assembled with many types of flange. We also offer many other special configurations, length and hole size to meet special requirements.

Note:

1. Customization is available;
2. For detailed information of each WICN-XX type high directional coupler, please visit the website: www.ainfoinc.com.

We can also provide the following types coupler, pls. see the outline drawing.

Four ports Dual Coupler



WUC Series

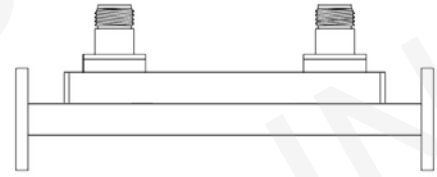

WUCN Series

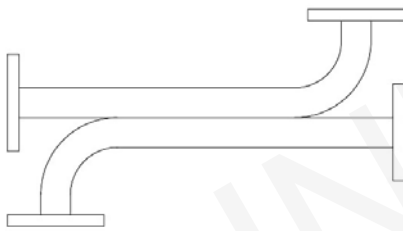

WXC Series

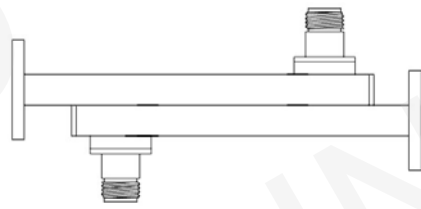

WXCN Series

Dual Directional Coupler

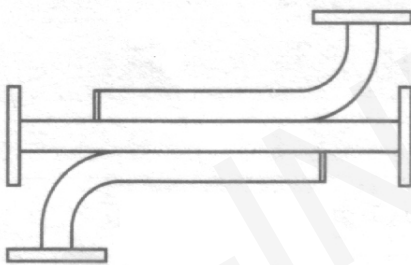

WDXC Series

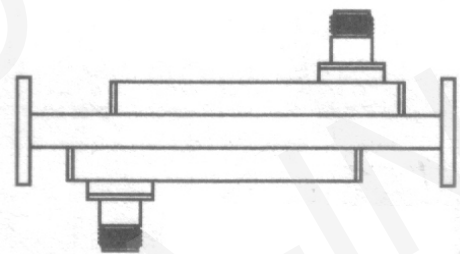

WDXCN Series

Six Ports Dual Coupler

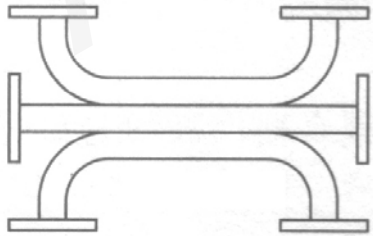

WDUC Series

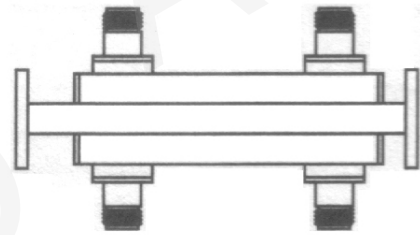

WDUCN Series

Same Directional Coupled Power Divider

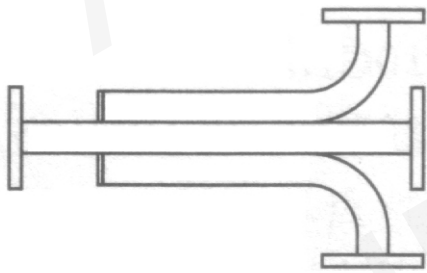

WDC Series

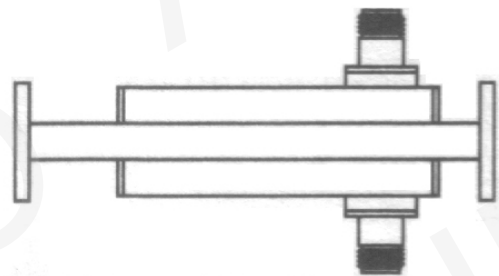

WDCN Series

Note:

For detailed information of above couplers, pls.feel free to contact us.

Waveguide Loop Coupler (WHC-XX Type)

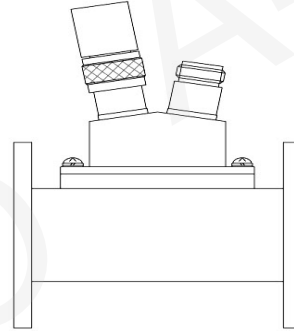

Standard Models									
P/N	Frequency Range (GHz)	Waveguide	Band Width	Coupling (dB)	VSWR Mainline	VSWR Secondline	Flange	Connector	Material
430WHC-XX	1.70-2.60	WR430	10%-20%	30/40/50/60	1.15	1.35	FDP22/ FDM22	N-F	Al/Cu
340WHC-XX	2.20-3.30	WR340	10%-20%	30/40/50/60	1.15	1.35	FDP26/ FDM26	N-F	Al/Cu
284WHC-XX	2.60-3.95	WR284	10%-20%	30/40/50/60	1.15	1.35	FDP32/ FDM32	N-F	Al/Cu
229WHC-XX	3.30-4.90	WR229	10%-20%	30/40/50/60	1.15	1.35	FDP40/ FDM40	N-F	Al/Cu
187WHC-XX	3.95-5.85	WR187	10%-20%	30/40/50/60	1.15	1.35	FDP40/ FDM40	N-F	Al/Cu
159WHC-XX	4.90-7.05	WR159	10%-20%	30/40/50/60	1.15	1.35	FDP48/ FDM48	N-F	Al/Cu
137WHC-XX	5.85-8.20	WR137	10%-20%	30/40/50/60	1.15	1.35	FDP70/ FDM70	N-F/SMA-F	Al/Cu
112WHC-XX	7.05-10.0	WR112	10%-20%	30/40/50/60	1.15	1.35	FBP84/ FBM84/ FBE84	N-F/SMA-F	Al/Cu
90WHC-XX	8.20-12.4	WR90	10%-20%	30/40/50/60	1.15	1.35	FBP100/ FBM100/ FBE100	N-F/SMA-F	Al/Cu

Ordering Information

P/N:

430 **WHC** - **XX**
 WR Size Product Code Coupling (dB)

Example: 430WHC-30 is a WR430 waveguide loop coupler. Coupling is 30dB.

AINFO manufactures wide variety of waveguide loop coupler assemblies specially designed for every customers unique requirements. Waveguide Loop Coupler can be assembled with many types of flange. We also offer many other special configurations, length and hole size to meet special requirements.

Note:

1. Customization is available;
2. For detailed information of each WHC-XX type waveguide loop coupler, please visit the website: www.ainfoinc.com.

Waveguide Loop Coupler (WHHC-XX Type)

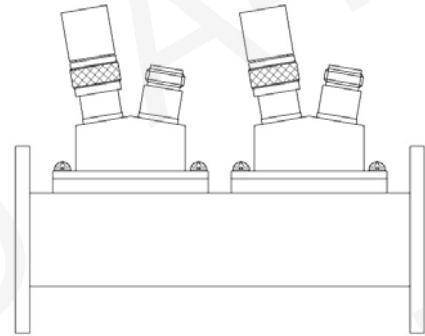

Standard Models									
P/N	Frequency Range (GHz)	Waveguide	Band Width	Coupling (dB)	VSWR Mainline	VSWR Secondline	Flange	Connector	Material
430WHHC-XX	1.70-2.60	WR430	10%-20%	30/40/50/60	1.15	1.35	FDP22/ FDM22	N-F	Al/Cu
340WHHC-XX	2.20-3.30	WR340	10%-20%	30/40/50/60	1.15	1.35	FDP26/ FDM26	N-F	Al/Cu
284WHHC-XX	2.60-3.95	WR284	10%-20%	30/40/50/60	1.15	1.35	FDP32/ FDM32	N-F	Al/Cu
229WHHC-XX	3.30-4.90	WR229	10%-20%	30/40/50/60	1.15	1.35	FDP40/ FDM40	N-F	Al/Cu
187WHHC-XX	3.95-5.85	WR187	10%-20%	30/40/50/60	1.15	1.35	FDP48/ FDM48	N-F	Al/Cu
159WHHC-XX	4.90-7.05	WR159	10%-20%	30/40/50/60	1.15	1.35	FDP58/ FDM58	N-F	Al/Cu
137WHHC-XX	5.85-8.20	WR137	10%-20%	30/40/50/60	1.15	1.35	FDP70/ FDM70	N-F/SMA-F	Al/Cu
112WHHC-XX	7.05-10.0	WR112	10%-20%	30/40/50/60	1.15	1.35	FBP84/ FBM84/ FBE84	N-F/SMA-F	Al/Cu
90WHHC-XX	8.20-12.4	WR90	10%-20%	30/40/50/60	1.15	1.35	FBP100/ FBM100/ FBE100	N-F/SMA-F	Al/Cu

Ordering Information

P/N:

340 **WHHC** - **XX**
 WR Size Product Code Coupling (dB)

Example: 340WHHC-30 is a WR340 waveguide loop coupler. Coupling is 30dB.

AINFO manufactures wide variety of waveguide loop coupler assemblies specially designed for every customers unique requirements.

Waveguide Loop Coupler can be assembled with many types of flange. We also offer many other special configurations, length and hole size to meet special requirements.

Note:

1. Customization is available;
2. For detailed information of each WHHC-XX waveguide loop coupler, please visit the website: www.ainfoinc.com.

Waveguide Loop Coupler (WDHC-XX Type)

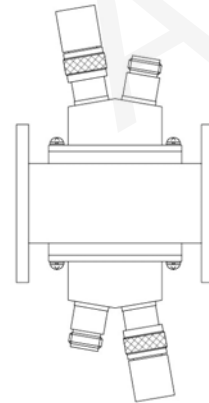

Standard Models

P/N	Frequency Range (GHz)	Waveguide	Band Width	Coupling (dB)	VSWR Mainline	VSWR Secondline	Flange	Connector	Material
430WDHC-XX	1.70-2.60	WR430	10%-20%	30/40/50/60	1.15	1.35	FDP22/ FDM22	N-F	Al/Cu
340WDHC-XX	2.20-3.30	WR340	10%-20%	30/40/50/60	1.15	1.35	FDP26/ FDM26	N-F	Al/Cu
284WDHC-XX	2.60-3.95	WR284	10%-20%	30/40/50/60	1.15	1.35	FDP32/ FDM32	N-F	Al/Cu
229WDHC-XX	3.30-4.90	WR229	10%-20%	30/40/50/60	1.15	1.35	FDP40/ FDM40	N-F	Al/Cu
187WDHC-XX	3.95-5.85	WR187	10%-20%	30/40/50/60	1.15	1.35	FDP48/ FDM48	N-F	Al/Cu
159WDHC-XX	4.90-7.05	WR159	10%-20%	30/40/50/60	1.15	1.35	FDP58/ FDM58	N-F	Al/Cu
137WDHC-XX	5.85-8.20	WR137	10%-20%	30/40/50/60	1.15	1.35	FDP70/ FDM70	N-F/SMA-F	Al/Cu
112WDHC-XX	7.05-10.0	WR112	10%-20%	30/40/50/60	1.15	1.35	FBP84/ FBM84/ FBE84	N-F/SMA-F	Al/Cu
90WDHC-XX	8.20-12.4	WR90	10%-20%	30/40/50/60	1.15	1.35	FBP100/ FBM100/ FBE100	N-F/SMA-F	Al/Cu

Ordering Information

P/N:

284 **WDHC** - **XX**
 WR Size Product Code Coupling (dB)

Example: 284WDHC-30 is a WR284 waveguide loop coupler. Coupling is 30dB.

AINFO manufactures wide variety of waveguide loop coupler assemblies specially designed for every customers unique requirements. Waveguide Loop Coupler can be assembled with many types of flange. We also offer many other special configurations, length and hole size to meet special requirements.

Note:

1. Customization is available;
2. For detailed information of each WDHC-XX type waveguide loop coupler, please visit the website: www.ainfoinc.com.

Waveguide Loop Coupler (WDHHC-XX Type)

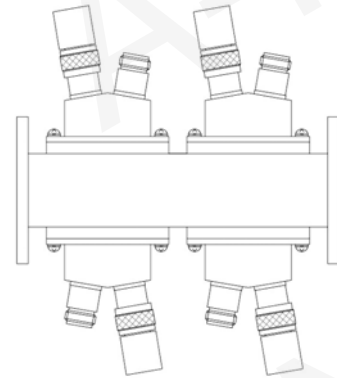

Standard Models

P/N	Frequency Range (GHz)	Waveguide	Band width	Coupling (dB)	VSWR Mainline	VSWR Secondline	Flange	Connector	Material
430WDHHC-XX	1.70-2.60	WR430	10%-20%	30/40/50/60	1.15	1.35	FDP22/ FDM22	N-F	Al/Cu
340WDHHC-XX	2.20-3.30	WR340	10%-20%	30/40/50/60	1.15	1.35	FDP26/ FDM26	N-F	Al/Cu
284WDHHC-XX	2.60-3.95	WR284	10%-20%	30/40/50/60	1.15	1.35	FDP32/ FDM32	N-F	Al/Cu
229WDHHC-XX	3.30-4.90	WR229	10%-20%	30/40/50/60	1.15	1.35	FDP40/ FDM40	N-F	Al/Cu
187WDHHC-XX	3.95-5.85	WR187	10%-20%	30/40/50/60	1.15	1.35	FDP48/ FDM48	N-F	Al/Cu
159WDHHC-XX	4.90-7.05	WR159	10%-20%	30/40/50/60	1.15	1.35	FDP58/ FDM58	N-F	Al/Cu
137WDHHC-XX	5.85-8.20	WR137	10%-20%	30/40/50/60	1.15	1.35	FDP70/ FDM70	N-F/SMA-F	Al/Cu
112WDHHC-XX	7.05-10.0	WR112	10%-20%	30/40/50/60	1.15	1.35	FBP84/ FBM84/ FBE84	N-F/SMA-F	Al/Cu
90WDHHC-XX	8.20-12.4	WR90	10%-20%	30/40/50/60	1.15	1.35	FBP100/ FBM100/ FBE100	N-F/SMA-F	Al/Cu

Ordering Information

P/N:

229 WDHHC - XX
 WR Product Coupling
 Size Code (dB)

Example: 229WDHHC-30 is a WR229 waveguide loop coupler. Coupling is 30dB.

Note:

1. Customization is available;
2. For detailed information of each WDHHC-XX type waveguide loop coupler, please visit the website: www.ainfoinc.com.

AINFO manufactures wide variety of waveguide loop coupler assemblies specially designed for every customers unique requirements.

Waveguide Loop Coupler can be assembled with many types of flange. We also offer many other special configurations, length and hole size to meet special requirements.

Waveguide Magic Tee

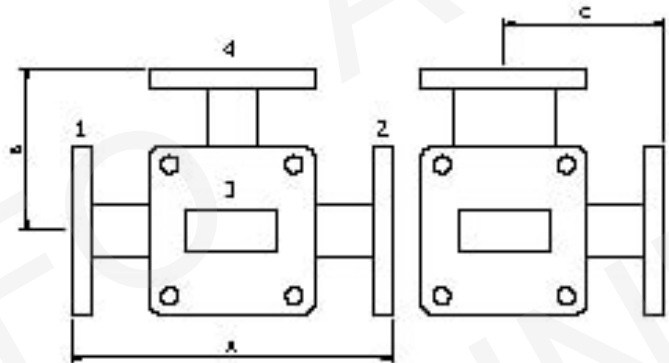

Standard Models									
P/N	Frequency Range (GHz)	Waveguide	Band Width	Unbalance (dB)	VSWR H-Plane	VSWR E-Plane	Isolation (dB)	Flange	Material
430WMT	1.70-2.60	WR430	10%-20%	±0.40	1.30	1.50	30	FDP22/ FDM22	Al/Cu
340WMT	2.20-3.30	WR340	10%-20%	±0.40	1.30	1.50	30	FDP26/ FDM26	Al/Cu
284WMT	2.60-3.95	WR284	10%-20%	±0.40	1.30	1.50	30	FDP32/ FDM32	Al/Cu
229WMT	3.30-4.90	WR229	10%-20%	±0.40	1.30	1.30	30	FDP40/ FDM40	Al/Cu
187WMT	3.95-5.85	WR187	10%-20%	±0.40	1.30	1.30	30	FDP48/ FDM48	Al/Cu
159WMT	4.90-7.05	WR159	10%-20%	±0.40	1.30	1.30	30	FDP58/ FDM58	Al/Cu
137WMT	5.85-8.20	WR137	10%-20%	±0.40	1.30	1.30	30	FDP70/ FDM70	Al/Cu
112WMT	7.05-10.0	WR112	10%-20%	±0.40	1.30	1.30	30	FBP84/ FBM84/ FBE84	Al/Cu
90WMT	8.20-12.4	WR90	10%-20%	±0.40	1.30	1.30	30	FBP100/ FBM100/ FBE100	Al/Cu
75WMT	10.0-15.0	WR75	10%-20%	±0.40	1.30	1.30	30	FBP120/ FBM120/ FBE120	Al/Cu
62WMT	12.4-18.0	WR62	10%-20%	±0.40	1.30	1.50	30	FBP140/ FBM140/ FBE140	Al/Cu
51WMT	15.0-22.0	WR51	10%-20%	±0.40	1.30	1.50	30	FBP180/ FBM180/ FBE180	Al/Cu
42WMT	18.0-26.5	WR42	10%-20%	±0.40	1.30	1.50	30	FBP220/ FBM220/ FBE220	Al/Cu
34WMT	22.0-33.0	WR34	10%-20%	±0.40	1.30	1.50	30	FBP260/ FBM260/ FBE260	Al/Cu

P/N	Frequency Range (GHz)	Waveguide	Band Width	Unbalance (dB)	VSWR H-Plane	VSWR E-Plane	Isolation (dB)	Flange	Material
28WMT	26.5-40.0	WR28	10%-20%	±0.40	1.30	1.50	30	FBP320/ FBM320/ FBE320	Al/Cu

Ordering Information

P/N:

51 **WMT**

WR Product
Size Code

AINFO manufactures wide variety of waveguide magic tee assemblies specially designed for every customers unique requirements.

Waveguide Magic Tee can be assembled with many types of flange. We also offer many other special configurations, length and hole size to meet special requirements.

Example: 51WMT is a WR51 waveguide magic tee.

Note:

1. Customization is available;
2. For detailed information of each waveguide magic tee, please visit the website: www.ainfoinc.com.

Waveguide ET

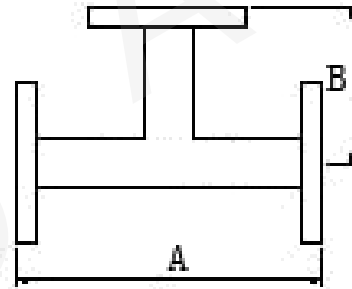

Standard Models

P/N	Frequency Range (GHz)	Waveguide	Band Width	Unbalance (dB)	VSWR	Flange	Material
650WET	1.12-1.70	WR650	10%-20%	±0.25	1.50	FDP14/FDM14	Al
510WET	1.45-2.20	WR510	10%-20%	±0.25	1.50	FDP18/FDM18	Al
430WET	1.70-2.60	WR430	10%-20%	±0.25	1.50	FDP22/FDM22	Al/Cu
340WET	2.20-3.30	WR340	10%-20%	±0.25	1.50	FDP26/FDM26	Al/Cu
284WET	2.60-3.95	WR284	10%-20%	±0.25	1.50	FDP32/FDM32	Al/Cu
229WET	3.30-4.90	WR229	10%-20%	±0.25	1.50	FDP40/FDM40	Al/Cu
187WET	3.95-5.85	WR187	10%-20%	±0.25	1.50	FDP48/FDM48	Al/Cu
159WET	4.90-7.05	WR159	10%-20%	±0.25	1.50	FDP58/FDM58	Al/Cu
137WET	5.85-8.20	WR137	10%-20%	±0.25	1.50	FDP70/FDM70	Al/Cu
112WET	7.05-10.0	WR112	10%-20%	±0.25	1.50	FBP84/FBM84/FBE84	Al/Cu
90WET	8.20-12.4	WR90	10%-20%	±0.25	1.50	FBP100/FBM100/FBE100	Al/Cu
75WET	10.0-15.0	WR75	10%-20%	±0.25	1.50	FBP120/FBM120/FBE120	Al/Cu
62WET	12.4-18.0	WR62	10%-20%	±0.25	1.50	FBP140/FBM140/FBE140	Al/Cu
51WET	15.0-22.0	WR51	10%-20%	±0.25	1.50	FBP180/FBM180/FBE180	Al/Cu
42WET	18.0-26.5	WR42	10%-20%	±0.30	1.50	FBP220/FBM220/FBE220	Al/Cu
34WET	22.0-33.0	WR34	10%-20%	±0.30	1.50	FBP260/FBM260/FBE260	Al/Cu
28WET	26.5-40.0	WR28	10%-20%	±0.30	1.50	FBP320/FBM320/FBE320	Al/Cu

Ordering Information

P/N:

42

WR Size

WET

Product Code

AINFO manufactures wide variety of waveguide ET assemblies specially designed for every customers unique requirements. Waveguide ET can be assembled with many types of flange. We also offer many other special configurations, length and hole size to meet special requirements.

Example: 42WET is a WR42 waveguide ET.

Note:

1. Customization is available;
2. For detailed information of each waveguide ET, please visit the website: www.ainfoinc.com.

Waveguide HT

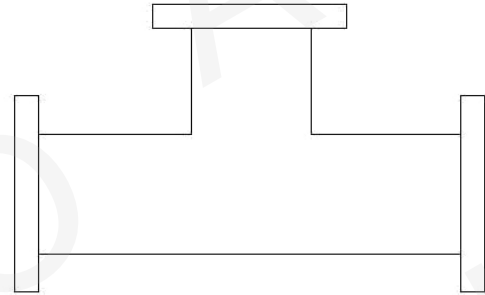

Standard Models							
P/N	Frequency Range (GHz)	Waveguide	Band Width	Unbalance (dB)	VSWR	Flange	Material
650WHT	1.12-1.70	WR650	10%-20%	±0.25	1.50	FDP14/FDM14	Al
510WHT	1.45-2.20	WR510	10%-20%	±0.25	1.50	FDP18/FDM18	Al
430WHT	1.70-2.60	WR430	10%-20%	±0.25	1.50	FDP22/FDM22	Al/Cu
340WHT	2.20-3.30	WR340	10%-20%	±0.25	1.50	FDP26/FDM26	Al/Cu
284WHT	2.60-3.95	WR284	10%-20%	±0.25	1.50	FDP32/FDM32	Al/Cu
229WHT	3.30-4.90	WR229	10%-20%	±0.25	1.50	FDP40/FDM40	Al/Cu
187WHT	3.95-5.85	WR187	10%-20%	±0.25	1.50	FDP48/FDM48	Al/Cu
159WHT	4.90-7.05	WR159	10%-20%	±0.25	1.50	FDP58/FDM58	Al/Cu
137WHT	5.85-8.20	WR137	10%-20%	±0.25	1.50	FDP70/FDM70	Al/Cu
112WHT	7.05-10.0	WR112	10%-20%	±0.25	1.50	FBP84/FBM84/FBE84	Al/Cu
90WHT	8.20-12.4	WR90	10%-20%	±0.25	1.50	FBP100/FBM100/FBE100	Al/Cu
75WHT	10.0-15.0	WR75	10%-20%	±0.25	1.50	FBP120/FBM120/FBE120	Al/Cu
62WHT	12.4-18.0	WR62	10%-20%	±0.25	1.50	FBP140/FBM140/FBE140	Al/Cu
51WHT	15.0-22.0	WR51	10%-20%	±0.25	1.50	FBP180/FBM180/FBE180	Al/Cu
42WHT	18.0-26.5	WR42	10%-20%	±0.30	1.50	FBP220/FBM220/FBE220	Al/Cu
34WHT	22.0-33.0	WR34	10%-20%	±0.30	1.50	FBP260/FBM260/FBE260	Al/Cu
28WHT	26.5-40.0	WR28	10%-20%	±0.30	1.50	FBP320/FBM320/FBE320	Al/Cu

Ordering Information	
<p>P/N:</p> <p style="text-align: center;"><u>34</u> <u>WHT</u></p> <p style="text-align: center;">WR Product Size Code</p> <p>Example: 34WHT is a WR34 waveguide HT.</p>	<p>AINFO manufactures wide variety of waveguide HT assemblies specially designed for every customers unique requirements. Waveguide HT can be assembled with many types of flange. We also offer many other special configurations, length and hole size to meet special requirements.</p>

<p>Note:</p> <ol style="list-style-type: none"> 1. Customization is available; 2. For detailed information of each waveguide HT, please visit the website: www.ainfoinc.com.
--

Waveguide Single Joint (I Type)

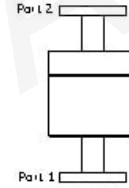

Standard Models									
P/N	Frequency Range (GHz)	Waveguide	Band Width (MHz)	VSWR	Insertion Loss (dB)	Average Power (W)	Peak Power (KW)	Flange	Material
284WRJI	2.60-3.95	WR284	200	1.20	0.3	600	600	FDP32/ FDM32	Al/Cu
229WRJI	3.30-4.90	WR229	200	1.20	0.3	600	600	FDP40/ FDM40	Al/Cu
187WRJI	3.95-5.85	WR187	200	1.20	0.3	600	600	FDP48/ FDM48	Al/Cu
159WRJI	4.90-7.05	WR159	300	1.25	0.3	500	150	FDP58/ FDM58	Al/Cu
137WRJI	5.85-8.20	WR137	300	1.25	0.3	500	150	FDP70/ FDM70	Al/Cu
112WRJI	7.05-10.0	WR112	300	1.25	0.3	400	150	FBP84/ FBM84/ FBE84	Al/Cu
90WRJI	8.20-12.4	WR90	300	1.25	0.3	400	150	FBP100/ FBM100/ FBE100	Al/Cu
75WRJI	10.0-15.0	WR75	500	1.25	0.3	200	10	FBP120/ FBM120/ FBE120	Al/Cu
62WRJI	12.4-18.0	WR62	1000	1.30	0.4	100	4	FBP140/ FBM140/ FBE140	Al/Cu
51WRJI	15.0-22.0	WR51	1000	1.30	0.4	100	3	FBP180/ FBM180/ FBE180	Al/Cu
42WRJI	18.0-26.5	WR42	2000	1.40	1.0	50	0.5	FBP220/ FBM220/ FBE220	Al/Cu
34WRJI	22.0-33.0	WR34	2000	1.40	1.0	30	0.3	FBP260/ FBM260/ FBE260	Al/Cu
28WRJI	26.5-40.0	WR28	2000	1.40	1.0	30	0.3	FBP320/ FBM320/ FBE320	Al/Cu

Ordering Information

P/N:

28

WR Size

WRJI

Product Code

Example: 28WRJI is an I type WR28 waveguide single joint.

Note:

1. Customization is available;
2. For detailed information of each I type waveguide single joint, please visit the website: www.ainfoinc.com.
3. Waveguide Dual-way Joint & Waveguide Three-way Joint also can be provided, for detailed information, pls. contact us.

AINFO manufactures wide variety of waveguide single joint assemblies specially designed for every customers unique requirements.

Waveguide Single Joint can be assembled with many types of flange. We also offer many other special configurations, length and hole size to meet special requirements.

Waveguide Single Joint (U Type)

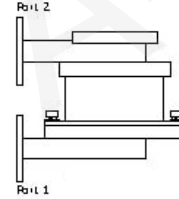

Standard Models									
P/N	Frequency Range (GHz)	Waveguide	Band Width (MHz)	VSWR	Insertion Loss (dB)	Average Power (W)	Peak Power (KW)	Flange	Material
284WRJU	2.60-3.95	WR284	200	1.20	0.3	600	600	FDP32/ FDM32	Al/Cu
229WRJU	3.30-4.90	WR229	200	1.20	0.3	600	600	FDP40/ FDM40	Al/Cu
187WRJU	3.95-5.85	WR187	200	1.20	0.3	600	600	FDP48/ FDM48	Al/Cu
159WRJU	4.90-7.05	WR159	300	1.25	0.3	500	150	FDP58/ FDM58	Al/Cu
137WRJU	5.85-8.20	WR137	300	1.25	0.3	500	150	FDP70/ FDM70	Al/Cu
112WRJU	7.05-10.0	WR112	300	1.25	0.3	400	150	FBP84/ FBM84/ FBE84	Al/Cu
90WRJU	8.20-12.4	WR90	300	1.25	0.3	400	150	FBP100/ FBM100/ FBE100	Al/Cu
75WRJU	10.0-15.0	WR75	500	1.25	0.3	200	10	FBP120/ FBM120/ FBE120	Al/Cu
62WRJU	12.4-18.0	WR62	1000	1.30	0.4	100	4	FBP140/ FBM140/ FBE140	Al/Cu
51WRJU	15.0-22.0	WR51	1000	1.30	0.4	100	3	FBP180/ FBM180/ FBE180	Al/Cu
42WRJU	18.0-26.5	WR42	2000	1.40	1.0	50	0.5	FBP220/ FBM220/ FBE220	Al/Cu
34WRJU	22.0-33.0	WR34	2000	1.40	1.0	30	0.3	FBP260/ FBM260/ FBE260	Al/Cu
28WRJU	26.5-40.0	WR28	2000	1.40	1.0	30	0.3	FBP320/ FBM320/ FBE320	Al/Cu

Ordering Information

P/N:

34 **WRJU**
WR Size Product Code

Example: 34WRJU is an U type WR34 waveguide single joint.

AINFO manufactures wide variety of waveguide single joint assemblies specially designed for every customers unique requirements. Waveguide Single Joint can be assembled with many types of flange. We also offer many other special configurations, length and hole size to meet special requirements.

Note:

1. Customization is available;
2. For detailed information of each U type waveguide single joint, please visit the website: www.ainfoinc.com.
3. Waveguide Dual-way Joint & Waveguide Three-way Joint also can be provide, for detailed information, pls. contact us.

Waveguide Single Joint (L Type)

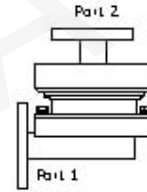

Standard Models									
P/N	Frequency Range (GHz)	Waveguide	Band Width (MHz)	VSWR	Insertion Loss (dB)	Average Power (W)	Peak Power (KW)	Flange	Material
284WRJL	2.60-3.95	WR284	200	1.20	0.3	600	600	FDP32/ FDM32	Al/Cu
229WRJL	3.30-4.90	WR229	200	1.20	0.3	600	600	FDP40/ FDM40	Al/Cu
187WRJL	3.95-5.85	WR187	200	1.20	0.3	600	600	FDP48/ FDM48	Al/Cu
159WRJL	4.90-7.05	WR159	300	1.25	0.3	500	150	FDP58/ FDM58	Al/Cu
137WRJL	5.85-8.20	WR137	300	1.25	0.3	500	150	FDP70/ FDM70	Al/Cu
112WRJL	7.05-10.0	WR112	300	1.25	0.3	400	150	FBP84/ FBM84/ FBE84	Al/Cu
90WRJL	8.20-12.4	WR90	300	1.25	0.3	400	150	FBP100/ FBM100/ FBE100	Al/Cu
75WRJL	10.0-15.0	WR75	500	1.25	0.3	200	10	FBP120/ FBM120/ FBE120	Al/Cu
62WRJL	12.4-18.0	WR62	1000	1.30	0.4	100	4	FBP140/ FBM140/ FBE140	Al/Cu
51WRJL	15.0-22.0	WR51	1000	1.30	0.4	100	3	FBP180/ FBM180/ FBE180	Al/Cu
42WRJL	18.0-26.5	WR42	2000	1.40	1.0	50	0.5	FBP220/ FBM220/ FBE220	Al/Cu
34WRJL	22.0-33.0	WR34	2000	1.40	1.0	30	0.3	FBP260/ FBM260/ FBE260	Al/Cu
28WRJL	26.5-40.0	WR28	2000	1.40	1.0	30	0.3	FBP320/ FBM320/ FBE320	Al/Cu

Ordering Information

P/N:

42

WR Size

WRJL

Product Code

Example: 42WRJL is a L type WR42 waveguide single joint.

AINFO manufactures wide variety of waveguide single joint assemblies specially designed for every customers unique requirements.

Waveguide Single Joint can be assembled with many types of flange. We also offer many other special configurations, length and hole size to meet special requirements.

Note:

1. Customization is available;
2. For detailed information of each L type waveguide single joint, please visit the website: www.ainfoinc.com.
3. Waveguide Dual-way Joint & Waveguide Three-way Joint also can be provide, for detailed information, pls. contact us.

Waveguide Low Power Load

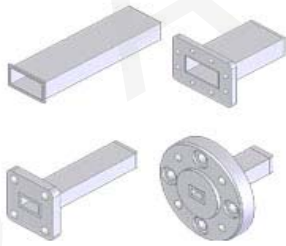

Standard Models

P/N	Frequency Range (GHz)	Waveguide	Power Handling (W)	VSWR	Flange	Material
975WLPL2	0.75-1.12	WR975	2	1.05	FDP9	Al
770WLPL2	0.96-1.45	WR770	2	1.05	FDP12	Al
650WLPL2	1.12-1.70	WR650	2	1.05	FDP14/FDM14	Al
510WLPL2	1.45-2.20	WR510	2	1.05	FDP18/FDM18	Al/Cu
430WLPL2	1.70-2.60	WR430	2	1.05	FDP22/FDM22	Al/Cu
340WLPL2	2.20-3.30	WR340	2	1.05	FDP26/FDM26	Al/Cu
284WLPL2	2.60-3.95	WR284	2	1.05	FDP32/FDM32	Al/Cu
229WLPL2	3.30-4.90	WR229	2	1.05	FDP40/FDM40	Al/Cu
187WLPL2	3.95-5.85	WR187	2	1.05	FDP48/FDM48	Al/Cu
159WLPL2	4.90-7.05	WR159	2	1.05	FDP58/FDM58	Al/Cu
137WLPL2	5.85-8.20	WR137	2	1.05	FDP70/FDM70	Al/Cu
112WLPL2	7.05-10.0	WR112	2	1.05	FBP84/FBM84/FBE84	Al/Cu
90WLPL2	8.20-12.4	WR90	2	1.05	FBP100/FBM100/FBE100	Al/Cu
75WLPL2	10.0-15.0	WR75	2	1.05	FBP120/FBM120/FBE120	Al/Cu
62WLPL2	12.4-18.0	WR62	2	1.05	FBP140/FBM140/FBE140	Al/Cu
51WLPL2	15.0-22.0	WR51	2	1.05	FBP180/FBM180/FBE180	Al/Cu
42WLPL2	18.0-26.5	WR42	2	1.05	FBP220/FBM220/FBE220	Al/Cu
34WLPL2	22.0-33.0	WR34	2	1.05	FBP260/FBM260/FBE260	Al/Cu
28WLPL2	26.5-40.0	WR28	2	1.05	FBP320/FBM320/FBE320	Al/Cu
22WLPL2	33.0-50.0	WR22	2	1.10	FUGP400	Cu
19WLPL2	40.0-60.0	WR19	2	1.10	FUGP500	Cu
15WLPL2	50.0-75.0	WR15	2	1.10	FUGP620	Cu
12WLPL2	60.0-90.0	WR12	2	1.10	FUGP740	Cu
10WLPL2	75.0-110.0	WR10	2	1.10	FUGP900	Cu

Ordering Information

P/N:

975

WR Size

WLPL

Product Code

2

Power Handling (W)

Example: 975WLPL2 is a WR975 waveguide low power load. Power is 2W.

Note:

1. Customization is available;
2. For detailed information of each waveguide low power load, please visit the website: www.ainfoinc.com.

AINFO manufactures wide variety of waveguide low power load assemblies specially designed for every customers unique requirements. Waveguide Low Power Load can be assembled with many types of flange. We also offer many other special configurations, length and hole size to meet special requirements.

Waveguide Medium Power Load

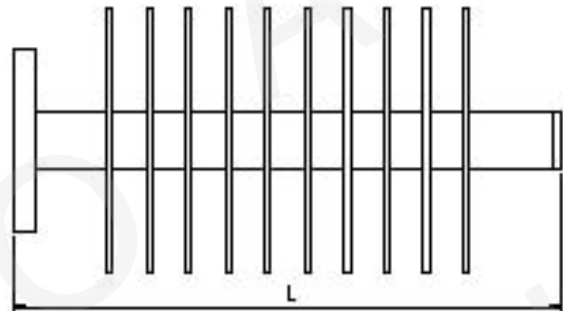

Standard Models

P/N	Frequency Range (GHz)	Waveguide	Power Handling (W)	VSWR	Flange	Material
510WMPLXX	1.45-2.20	WR510	100	1.25	FDP18/FDM18	Al/Cu
430WMPLXX	1.70-2.60	WR430	100	1.25	FDP22/FDM22	Al/Cu
340WMPLXX	2.20-3.30	WR340	100	1.25	FDP26/FDM26	Al/Cu
284WMPLXX	2.60-3.95	WR284	50/100	1.25	FDP32/FDM32	Al/Cu
229WMPLXX	3.30-4.90	WR229	50/100	1.25	FDP40/FDM40	Al/Cu
187WMPLXX	3.95-5.85	WR187	50/100	1.25	FDP48/FDM48	Al/Cu
159WMPLXX	4.90-7.05	WR159	50/100	1.25	FDP58/FDM58	Al/Cu
137WMPLXX	5.85-8.20	WR137	50/100	1.25	FDP70/FDM70	Al/Cu
112WMPLXX	7.05-10.0	WR112	50/100	1.25	FBP84/FBM84/FBE84	Al/Cu
90WMPLXX	8.20-12.4	WR90	50/100	1.25	FBP100/FBM100/FBE100	Al/Cu
75WMPLXX	10.0-15.0	WR75	50/100	1.25	FBP120/FBM120/FBE120	Al/Cu
62WMPLXX	12.4-18.0	WR62	50/100	1.25	FBP140/FBM140/FBE140	Al/Cu
51WMPLXX	15.0-22.0	WR51	50/100	1.25	FBP180/FBM180/FBE180	Al/Cu
42WMPLXX	18.0-26.5	WR42	50/100	1.25	FBP220/FBM220/FBE220	Al/Cu
34WMPLXX	22.0-33.0	WR34	50/100	1.25	FBP260/FBM260/FBE260	Al/Cu
28WMPLXX	26.5-40.0	WR28	50/100	1.25	FBP320/FBM320/FBE320	Al/Cu

Ordering Information

P/N:

510

WR
Size

WMPL

Product
Code

XX

Power
Handling
(W)

Example: 510WMPL100 is a WR510 waveguide medium power load. Power is 100W.

Note:

1. Customization is available;
2. For detailed information of each waveguide medium power load, please visit the website: www.ainfoinc.com.

AINFO manufactures wide variety of waveguide medium power load assemblies specially designed for every customers unique requirements.

Waveguide Medium Power Load can be assembled with many types of flange. We also offer many other special configurations, length and hole size to meet special requirements.

Waveguide High Power Load

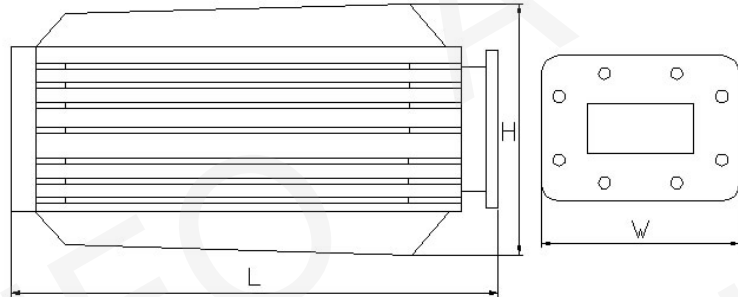

Standard Models						
P/N	Frequency Range (GHz)	Waveguide	Power Handling (W)	VSWR	Flange	Material
510WHPLXX	1.45-2.20	WR510	100-4000	1.35	FDP18/FDM18	Al/Cu
430WHPLXX	1.70-2.60	WR430	100-4000	1.35	FDP22/FDM22	Al/Cu
340WHPLXX	2.20-3.30	WR340	100-4000	1.35	FDP26/FDM26	Al/Cu
284WHPLXX	2.60-3.95	WR284	100-4000	1.35	FDP32/FDM32	Al/Cu
229WHPLXX	3.30-4.90	WR229	100-4000	1.35	FDP40/FDM40	Al/Cu
187WHPLXX	3.95-5.85	WR187	100-4000	1.35	FDP48/FDM48	Al/Cu
159WHPLXX	4.90-7.05	WR159	100-4000	1.35	FDP58/FDM58	Al/Cu
137WHPLXX	5.85-8.20	WR137	100-4000	1.35	FDP70/FDM70	Al/Cu
112WHPLXX	7.05-10.0	WR112	100-3000	1.35	FBP84/FBM84/FBE84	Al/Cu
90WHPLXX	8.20-12.4	WR90	100-3000	1.35	FBP100/FBM100/FBE100	Al/Cu
75WHPLXX	10.0-15.0	WR75	100-3000	1.35	FBP120/FBM120/FBE120	Al/Cu
62WHPLXX	12.4-18.0	WR62	100-1000	1.35	FBP140/FBM140/FBE140	Al/Cu
51WHPLXX	15.0-22.0	WR51	100-1000	1.35	FBP180/FBM180/FBE180	Al/Cu
42WHPLXX	18.0-26.5	WR42	100-600	1.35	FBP220/FBM220/FBE220	Al/Cu
34WHPLXX	22.0-33.0	WR34	100-600	1.35	FBP260/FBM260/FBE260	Al/Cu
28WHPLXX	26.5-40.0	WR28	100-600	1.35	FBP320/FBM320/FBE320	Al/Cu

Ordering Information		
P/N:		
510	WHPL	XX
WR Size	Product Code	Power Handling (W)
<p>Example: 510WHPL4000 is a WR510 waveguide high power load. Power is 4000W.</p>		
<p>Note:</p> <ol style="list-style-type: none"> 1. Customization is available; 2. For detailed information of each waveguide high power load, please visit the website: www.ainfoinc.com. 		

AINFO manufactures wide variety of waveguide high power load assemblies specially designed for every customers unique requirements. Waveguide High Power Load can be assembled with many types of flange. We also offer many other special configurations, length and hole size to meet special requirements.

Waveguide Fixed Attenuator



Standard Models						
P/N	Frequency Range (GHz)	Waveguide	Attenuation (dB)	VSWR	Flange	Material
650WFA-XX	1.12-1.70	WR650	3/6/10/20/30	1.25	FDP14/FDM14	Al
510WFA-XX	1.45-2.20	WR510	3/6/10/20/30	1.25	FDP18/FDM18	Al
430WFA-XX	1.70-2.60	WR430	3/6/10/20/30	1.25	FDP22/FDM22	Al/Cu
340WFA-XX	2.20-3.30	WR340	3/6/10/20/30	1.25	FDP26/FDM26	Al/Cu
284WFA-XX	2.60-3.95	WR284	3/6/10/20/30	1.25	FDP32/FDM32	Al/Cu
229WFA-XX	3.30-4.90	WR229	3/6/10/20/30	1.25	FDP40/FDM40	Al/Cu
187WFA-XX	3.95-5.85	WR187	3/6/10/20/30	1.25	FDP48/FDM48	Al/Cu
159WFA-XX	4.90-7.05	WR159	3/6/10/20/30	1.25	FDP58/FDM58	Al/Cu
137WFA-XX	5.85-8.20	WR137	3/6/10/20/30	1.25	FDP70/FDM70	Al/Cu
112WFA-XX	7.05-10.0	WR112	3/6/10/20/30	1.25	FBP84/FBM84/FBE84	Al/Cu
90WFA-XX	8.20-12.4	WR90	3/6/10/20/30	1.25	FBP100/FBM100/FBE100	Al/Cu
75WFA-XX	10.0-15.0	WR75	3/6/10/20/30	1.25	FBP120/FBM120/FBE120	Al/Cu
62WFA-XX	12.4-18.0	WR62	3/6/10/20/30	1.25	FBP140/FBM140/FBE140	Al/Cu
51WFA-XX	15.0-22.0	WR51	3/6/10/20/30	1.25	FBP180/FBM180/FBE180	Al/Cu
42WFA-XX	18.0-26.5	WR42	3/6/10/20/30	1.25	FBP220/FBM220/FBE220	Al/Cu
34WFA-XX	22.0-33.0	WR34	3/6/10/20/30	1.25	FBP260/FBM260/FBE260	Al/Cu
28WFA-XX	26.5-40.0	WR28	3/6/10/20/30	1.25	FBP320/FBM320/FBE320	Al/Cu
22WFA-XX	33.0-50.0	WR22	3/6/10/20/30	1.30	FUGP400	Cu
19WFA-XX	40.0-60.0	WR19	3/6/10/20/30	1.30	FUGP500	Cu
15WFA-XX	50.0-75.0	WR15	3/6/10/20/30	1.30	FUGP620	Cu
12WFA-XX	60.0-90.0	WR12	3/6/10/20/30	1.30	FUGP740	Cu
10WFA-XX	75.0-110.0	WR10	3/6/10/20/30	1.30	FUGP900	Cu

Ordering Information

P/N:

22 **WFA** = **XX**
 WR Size Product Code Attenuation (dB)

Example: 22WFA-10 is a WR22 waveguide fixed attenuator. Attenuation is 10dB.

AINFO manufactures wide variety of waveguide fixed attenuator assemblies specially designed for every customers unique requirements. Waveguide Fixed Attenuator can be assembled with many types of flange. We also offer many other special configurations, length and hole size to meet special requirements.

Note:

1. Customization is available;
2. For detailed information of each waveguide fixed attenuator, please visit the website: www.ainfoinc.com.

Waveguide Variable Attenuator

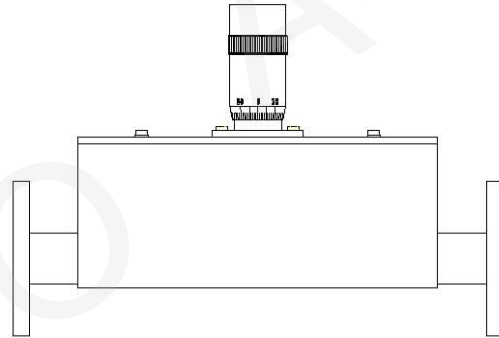

Standard Models

P/N	Frequency Range (GHz)	Waveguide	Attenuation (dB)	VSWR	Flange	Material
90WVA-XX	8.20-12.4	WR90	0-30	1.25	FBP100/FBM100/FBE100	Al/Cu
75WVA-XX	10.0-15.0	WR75	0-30	1.25	FBP120/FBM120/FBE120	Al/Cu
62WVA-XX	12.4-18.0	WR62	0-30	1.25	FBP140/FBM140/FBE140	Al/Cu
51WVA-XX	15.0-22.0	WR51	0-30	1.25	FBP180/FBM180/FBE180	Al/Cu
42WVA-XX	18.0-26.5	WR42	0-30	1.25	FBP220/FBM220/FBE220	Al/Cu
34WVA-XX	22.0-33.0	WR34	0-30	1.25	FBP260/FBM260/FBE260	Al/Cu
28WVA-XX	26.5-40.0	WR28	0-30	1.25	FBP320/FBM320/FBE320	Al/Cu

Ordering Information

P/N:

90 **WVA** = **XX**
 WR Size Product Code Attenuation (dB)

Example: 90WVA-30 is a WR90 waveguide variable attenuator.

AINFO manufactures wide variety of waveguide variable attenuator assemblies specially designed for every customers unique requirements. Waveguide Variable Attenuator can be assembled with many types of flange. We also offer many other special configurations, length and hole size to meet special requirements.

Note:

1. Customization is available;
2. For detailed information of each waveguide variable attenuator, please visit the website: www.ainfoinc.com.

Waveguide Circulator

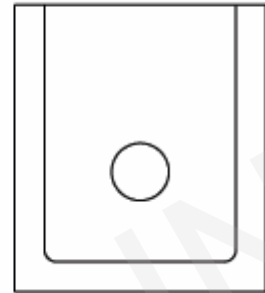
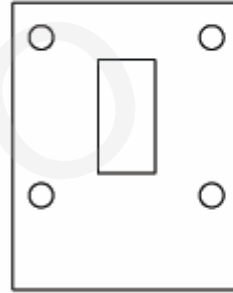

Standard Models									
P/N	Frequency Range (GHz)	Waveguide	Band Width (MHz)	Insertion Loss (dB)	Isolation (dB)	VSWR	Average Power (W)	Operating Temp. (°C)	Flange
284WCIC	2.70-3.10	WR284	Full	0.5	20	1.25	200	-55~+85	FDP32/ FDM32
187WCIC	4.4-5.0	WR187	Full	0.3	20	1.25	600	-55~+85	FDP48 FDM48
159WCIC	5.4-5.8	WR159	Full	0.4	20	1.25	200	-55~+85	FDP58/ FDM58
112WCIC	9.07-9.67	WR112	Full	0.5	20	1.25	300	-55~+85	FDP84/ FDM84
62WCIC	12.36-16.7	WR62	Full	0.5	20	1.25	100	-55~+85	FBP140/ FBM140/ FBE140
42WCIC	18.0-26.5	WR42	2000	0.4	20	1.25	50	-40~+70	FBP220/ FBM220/ FBE220
34WCIC	24.0-27.0	WR34	Full	0.4	20	1.25	50	-40~+70	FBP260/ FBM260/ FBE260

Ordering Information

P/N:

284

WR Size

WCIC

Product
Code

AINFO manufactures wide variety of waveguide circulator assemblies specially designed for every customers unique requirements. Waveguide Circulator can be assembled with many types of flange. We also offer many other special configurations, length and hole size to meet special requirements.

Example: 284CICI is a WR284 waveguide circulator.

Note:

1. Customization is available;
2. For detailed information of each waveguide circulator, please visit the website: www.ainfoinc.com.

Waveguide Isolator

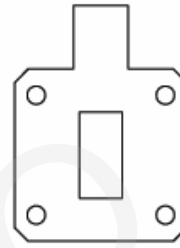

Standard Models									
P/N	Frequency Range (GHz)	Waveguide	Band Width (MHz)	Insertion Loss (dB)	Isolation (dB)	VSWR	Average Power (W)	Operating Temp. (°C)	Flange
284WISO	3.13-3.47	WR284	Full	0.5	20	1.25	200	-55~+85	FDP32/ FDM32
90WISO-1	8.0-10.5	WR90	500	0.3	22	1.2	10	-45~+75	FBP100 FBM100 FBE100
90WISO-2	10.0-10.3	WR90	Full	0.4	22	1.2	200	-55~+85	FBP100 FBM100 FBE100
75WISO	12.5-13.5	WR75	500	0.4	22	1.2	10	-45~+75	FBP120 FBM120 FBE120
62WISO-1	13.0-16.0	WR62	1000	0.4	20	1.2	100	-40~+70	FBP140 FBM140 FBE140
62WISO-2	13.0-16.0	WR62	600	0.3	22	1.2	30	-55~+85	FBP140 FBM140 FBE140
51WISO	16.0-17.0	WR51	500	0.5	25	1.18	100	-55~+85	FBP180 FBM180 FBE180
42WISO-1	18.0-26.5	WR42	1000	0.4	20	1.25	10	-40~+70	FBP220 FBM220 FBE220
42WISO-2	21.0-23.0	WR42	2000	0.5	20	1.25	10	-40~+70	FBP220 FBM220 FBE220
34WISO	25.0-27.0	WR34	Full	0.4	20	1.25	10	-40~+70	FBP260 FBM260 FBE260

Ordering Information

P/N:

34 **WISO**
 WR Size Product Code

Example: 34WISO is a WR34 waveguide isolator.

AINFO manufactures wide variety of waveguide isolator assemblies specially designed for every customers unique requirements. Waveguide Isolator can be assembled with many types of flange. We also offer many other special configurations, length and hole size to meet special requirements.

Note:

1. Customization is available;
2. For detailed information of each waveguide isolator, please visit the website: www.ainfoinc.com.

Electric Double Ridge Waveguide Switch



Standard Models						
P/N	Frequency Range (GHz)	Waveguide	VSWR	Insertion Loss (dB)	Isolation (dB)	Switching Speed (ms)
580DRWHSMD	5.8-16.0	WRD580D28	1.2	0.3	50	60
580DRWESMD	5.8-16.0	WRD580D28	1.2	0.3	50	60
650DRWHSMD	6.5-18.0	WRD650D28	1.2	0.3	50	60
650DRWESMD	6.5-18.0	WRD650D28	1.2	0.3	50	60
750DRWHSMD	7.5-18.0	WRD750D24	1.2	0.3	50	60
750DRWESMD	7.5-18.0	WRD750D24	1.2	0.3	50	60
110DRWHSMD	11.0-26.5	WRD110C24	1.2	0.3	50	60
110DRWESMD	11.0-26.5	WRD110C24	1.2	0.3	50	60
180DRWHSMD	18.0-40.0	WRD180C24	1.2	0.3	50	60
180DRWESMD	18.0-40.0	WRD180C24	1.2	0.3	50	60

<p>Ordering Information</p> <p>P/N:</p> <p style="text-align: center;"><u>580DR</u> <u>WHSMD</u></p> <p style="text-align: center;">WR Size Product Code</p> <p>Example: 580DRWHSMD is a WRD580D28 electric double ridge waveguide switch.</p> <p>Note:</p> <ol style="list-style-type: none"> 1. Customization is available; 2. For detailed information of each electric double ridge waveguide switch, please visit the website: www.ainfoinc.com. 	<p>AINFO manufactures wide variety of electric double ridge waveguide switch assemblies specially designed for every customers unique requirements. Electric Double Ridge Waveguide Switch can be assembled with many types of flange. We also offer many other special configurations, length and hole size to meet special requirements.</p>
--	--

Waveguide Short Plates

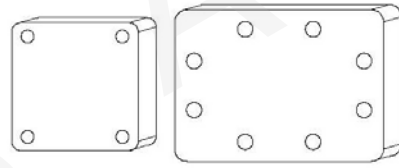

Standard Models						
P/N	Frequency Range (GHz)	Waveguide	VSWR	Thickness (mm)	Flange	Material
975WS	0.75-1.12	WR975	60	14	D-Type	Al
770WS	0.96-1.45	WR770	60	12	D-Type	Al
650WS	1.12-1.70	WR650	60	12	D-Type	Al
510WS	1.45-2.20	WR510	60	12	D-Type	Al/Cu
430WS	1.70-2.60	WR430	60	10	D-Type	Al/Cu
340WS	2.20-3.30	WR340	60	10	D-Type	Al/Cu
284WS	2.60-3.95	WR284	60	8	D-Type	Al/Cu
229WS	3.30-4.90	WR229	60	8	D-Type	Al/Cu
187WS	3.95-5.85	WR187	60	7	D-Type	Al/Cu
159WS	4.90-7.05	WR159	60	7	D-Type	Al/Cu
137WS	5.85-8.20	WR137	60	7	D-Type	Al/Cu
112WS	7.05-10.0	WR112	60	5	B-Type	Al/Cu
90WS	8.20-12.4	WR90	60	5	B-Type	Al/Cu
75WS	10.0-15.0	WR75	60	5	B-Type	Al/Cu
62WS	12.4-18.0	WR62	60	5	B-Type	Al/Cu
51WS	15.0-22.0	WR51	60	5	B-Type	Al/Cu
42WS	18.0-26.5	WR42	60	4	B-Type	Al/Cu
34WS	22.0-33.0	WR34	60	4	B-Type	Al/Cu
28WS	26.5-40.0	WR28	60	4	B-Type	Al/Cu
22WS	33.0-50.0	WR22	60	4	FUGP-Type	Cu
19WS	40.0-60.0	WR19	60	4	FUGP-Type	Cu
15WS	50.0-75.0	WR15	60	4	FUGP-Type	Cu
12WS	60.0-90.0	WR12	60	4	FUGP-Type	Cu
10WS	75.0-110.0	WR10	60	4	FUGP-Type	Cu

Ordering Information

P/N:

10

WR Size

WS

Product Code

AINFO manufactures wide variety of waveguide short plates assemblies specially designed for every customers unique requirements.

Waveguide Short Plates can be assembled with many types of flange. We also offer many other special configurations, length and hole size to meet special requirements.

Example: 10WS is a WR10 waveguide short plates

Note:

1. Customization is available;
2. For detailed information of each waveguide short plates, please visit the website: www.ainfoinc.com.

1/4 Waveguide Offset Short

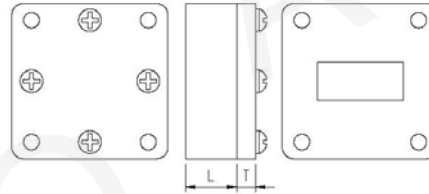

Standard Models							
P/N	Frequency Range (GHz)	Waveguide	VSWR	Size (mm)		Flange	Material
				T	L		
975WOFS	0.75-1.12	WR975	50	14	112.7	FDP9	Al
770WOFS	0.96-1.45	WR770	50	12	81.3	FDP12	Al
650WOFS	1.12-1.70	WR650	50	12	70.4	FDP14/FDM14	Al
510WOFS	1.45-2.20	WR510	50	12	54.4	FDP18/FDM18	Al
430WOFS	1.70-2.60	WR430	50	10	43.6	FDP22/FDM22	Al/Cu
340WOFS	2.20-3.30	WR340	50	10	38.8	FDP26/FDM26	Al/Cu
284WOFS	2.60-3.95	WR284	50	8	30.8	FDP32/FDM32	Al/Cu
229WOFS	3.30-4.90	WR229	50	8	24.5	FDP40/FDM40	Al/Cu
187WOFS	3.95-5.85	WR187	50	7	20.7	FDP48/FDM48	Al/Cu
159WOFS	4.90-7.05	WR159	50	7	16.8	FDP58/FDM58	Al/Cu
137WOFS	5.85-8.20	WR137	50	7	13.6	FDP70/FDM70	Al/Cu
112WOFS	7.05-10.0	WR112	50	5	11.5	FBP84/FBM84/FBE84	Al/Cu
90WOFS	8.20-12.4	WR90	50	5	9.9	FBP100/FBM100/FBE100	Al/Cu
75WOFS	10.0-15.0	WR75	50	5	8.3	FBP120/FBM120/FBE120	Al/Cu
62WOFS	12.4-18.0	WR62	50	5	7.3	FBP140/FBM140/FBE140	Al/Cu
51WOFS	15.0-22.0	WR51	50	5	5.4	FBP180/FBM180/FBE180	Al/Cu
42WOFS	18.0-26.5	WR42	50	4	4.4	FBP220/FBM220/FBE220	Al/Cu
34WOFS	22.0-33.0	WR34	50	4	3.9	FBP260/FBM260/FBE260	Al/Cu
28WOFS	26.5-40.0	WR28	50	4	3.1	FBP320/FBM320/FBE320	Al/Cu
22WOFS	33.0-50.0	WR22	50	4	2.5	FUGP400	Cu
19WOFS	40.0-60.0	WR19	50	4	1.9	FUGP500	Cu
15WOFS	50.0-75.0	WR15	50	4	1.6	FUGP620	Cu
12WOFS	60.0-90.0	WR12	50	4	1.3	FUGP740	Cu
10WOFS	75.0-110.0	WR10	50	4	1.1	FUGP900	Cu

Ordering Information

P/N:

12

WR Size

WOFS

Product Code

Example: 12WOFS is a WR12 1/4 waveguide offset short.

Note:

1. Customization is available;
2. For detailed information of each 1/4 waveguide offset shorts, please visit the website: www.ainfoinc.com.

AINFO manufactures wide variety of 1/4 waveguide offset short assemblies specially designed for every customers unique requirements.

1/4 Waveguide Offset Shorts can be assembled with many types of flange. We also offer many other special configurations, length and hole size to meet special requirements.

Flexible Waveguide



Standard Models									
P/N	Frequency Range (GHz)	Waveguide	VSWR	Attenuation (dB/m)	Average Power (KW)	Inner size (mm)	Airpress (MPa) Max.	Bend Radius (mm)Min.	
								E-Bend	H-Bend
430WF-XX	1.70-2.60	WR430	1.15	0.13	20	109.22x54.61	0.2	312	624
340WF-XX	2.20-3.30	WR340	1.15	0.15	20	86.36x43.18	0.2	260	520
284WF-XX	2.60-3.95	WR284	1.15	0.16	10	72.14x34.04	0.2	204	408
229WF-XX	3.30-4.90	WR229	1.15	0.18	8	58.17x29.08	0.2	166	332
187WF-XX	3.95-5.85	WR187	1.15	0.2	6.5	47.55x22.15	0.2	160	320
159WF-XX	4.90-7.05	WR159	1.15	0.25	6	40.39x20.19	0.2	129	258
	5.725-6.425		1.10						
137WF-XX	5.85-8.20	WR137	1.15	0.30	5	34.85x15.8	0.2	100	200
	7.125-7.725		1.10						
112WF-XX	7.05-10.0	WR112	1.15	0.35	4	28.5x12.6	0.2	76	152
	7.725-8.50		1.10						
90WF-XX	8.20-12.4	WR90	1.15	0.45	2	22.86x10.16	0.2	66	120
	10.7-11.7		1.10						
75WF-XX	10.0-15.0	WR75	1.20	0.65	1.50	19.05x9.525	0.2	64	120
	13.75-14.5		1.15						
62WF-XX	12.4-18.0	WR62	1.20	0.74	1	15.8x7.9	0.2	54	105
28WF-XX	26.5-40.0	WR28	1.40	2.5	0.15	7.112x3.556	0.2	20	40

Ordering Information

P/N:

112 **WF** - **XX**
 WR Size Product Code Length (mm)

Example: 112WF-300 is a WR112 flexible waveguide. Length is 300mm.

AINFO manufactures wide variety of flexible waveguide assemblies specially designed for every customers unique requirements. Flexible Waveguide can be assembled with many types of flange. We also offer many other special configurations, length and hole size to meet special requirements.

Note:

1. Customization is available;
2. For detailed information of each flexible waveguide, please visit the website: www.ainfoinc.com.

Flexible Twist Waveguide



Standard Models									
P/N	Frequency Range (GHz)	Waveguide	VSWR	Attenuation (dB/m)	Average Power (KW)	Inner size (mm)	Twist (deg/m) Max.	Bend Radius (mm) Min.	
								E-Bend	H-Bend
159WFT-XX	4.90-7.05	WR159	1.15	0.25	2.50	40.39x20.19	170	129	258
	5.725-6.425		1.10						
137WFT-XX	5.85-8.20	WR137	1.15	0.30	2.00	34.85x15.8	205	100	200
	5.85-6.425		1.10						
	6.425-7.125		1.10						
	7.125-7.725		1.10						
112WFT-XX	7.05-10.0	WR112	1.15	0.40	1.20	28.5x12.6	262	76	152
	7.125-7.725		1.10						
	7.725-8.50		1.10						
90WFT-XX	8.20-12.4	WR90	1.15	0.45	0.96	22.86x10.16	308	66	120
	10.7-11.7		1.10						
75WFT-XX	10.0-15.0	WR75	1.20	0.65	0.75	19.05x9.525	430	64	120
	12.75-13.25		1.15						
	13.75-14.5		1.15						
62WFT-XX	12.4-18.0	WR62	1.20	0.95	0.40	15.8x7.9	436	54	105

Ordering Information

P/N:

159 **WFT** - **XX**
 WR Size Product Code Length (mm)

Example: 159WFT-300 is a WR159 flexible twist waveguide. Length is 300mm.

AINFO manufactures wide variety of flexible twist waveguide assemblies specially designed for every customers unique requirements. Flexible Twist Waveguide can be assembled with many types of flange. We also offer many other special configurations, length and hole size to meet special requirements.

Note:

1. Customization is available;
2. For detailed information of each flexible twist waveguide, please visit our website: www.ainfoinc.com.

Elliptical Waveguide



Standard Models

P/N	Frequency Range (GHz)	VSWR	Attenuation (dB/100m)	Group Delay (ns/100m)	Peak Power (KW)	Dimensions (mm)	Weight (Kg/m)	Bend Radius (mm) Min.	
								E-Bend	H-Bend
WE26-XX	2.5-2.7	1.30	2	423	460	108.4x61.3	2.5	600	1500
WE38-XX	3.4-4.2	1.15	3.6(3.4GHz) 2.6(4.2GHz)	419	310	82.6x47.4	1.7	340	840
WE48-XX	4.4-5.0	1.15	4.7(4.4GHz) 3.8(5.0GHz)	413	190	72x42	1.4	300	750
WE54-XX	5.0-6.0	1.15	5.3(5.0GHz) 4.3(6.0GHz)	413	150	58.5x38	1	240	580
WE62-XX	5.925-7.125	1.15	5.2(5.9GHz) 4.5(7.1GHz)	411	102	52x30	0.85	220	550
WE80-XX	7.125-8.5	1.15	6.3(7.1GHz) 5.6(8.2GHz)	415	60	44.8x27.6	0.72	200	520
WE90-XX	8.6-10.0	1.20	11.2(8.6GHz) 9.5(10.0GHz)	405	40	34x24	0.6	160	350
WE110-XX	10.7-11.7	1.20	10.3(10.7GHz) 9.8(11.7GHz)	405	35	33x21	0.5	150	300
WE120-XX	10.95-12.75	1.25	10	415	35	29x15	0.4	150	300
WE130-XX	12.275-13.25	1.15	11.4(12.2GHz) 11.2(13.2GHz)	414	30	29.5x14.5	0.4	150	300
WE148-XX	14.0-15.35	1.25	16.5(14.0GHz) 15.5(15.4GHz)	425	20	25.3x16	0.34	150	350
WE188-XX	17.7-19.7	1.30	20.5(17.7GHz) 19.0(19.7GHz)	416	7	23.6x16.1	0.22	150	380

Ordering Information

P/N:

WE26 - **XX**
 Product Code Length (mm)

Example: WE26-200 is an elliptical waveguide, Length is 200mm.

Note:

1. Customization is available;
2. For detailed information of each elliptical waveguide, please visit the website: www.ainfoinc.com.

AINFO manufactures wide variety of elliptical waveguide assemblies specially designed for every customers unique requirements. Elliptical Waveguide can be assembled with many types of flange. We also offer many other special configurations, length and hole size to meet special requirements.

Chengdu AINFO Inc.

Contact us

Address: Suite# 10-2-301, #1 TongZiLin East Road,
Chengdu, China, Post Code: 610041

Tel: +86-28-8816-3497, +86-28-8519-2786

Fax: +86-28-8519-3068

Website: www.ainfoinc.com

Email: sales@ainfoinc.com