



Test report is for reference only.

**TEST REPORT**  
**For**  
**JXWBHP-T-50-3000-10**



## Technical Specification

RF/LO( GHz)	0.05 – 3
IF( GHz)	DC – 1
LO Power( dBm)	+10
Isolation L-R( dB)	25 typ.
Isolation L-I( dB )	25 typ.
Conversion Loss( dB)	7.5 typ.
Pin @ 1dB( dBm)	+5
Connectors	SMA-Female
Operating Temperature( °C)	-40 ~ +70
Storage Temperature( °C)	-55 ~ +85
Net Weight(Kg)	0.035

## Outline Drawing (Size: mm)

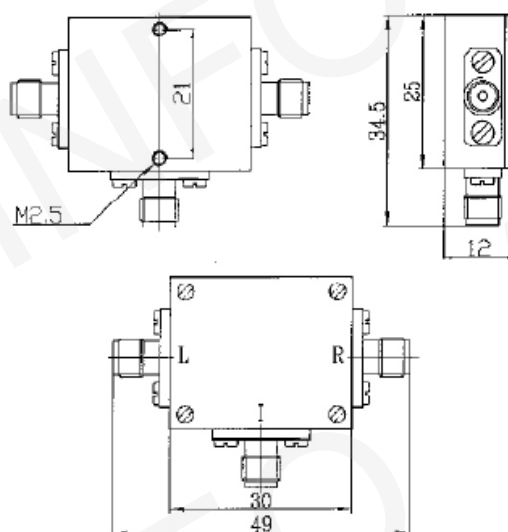

## Test Results

RF/ LO (GHz)	IF (GHz)	LO Power (dBm)	Isolation(dB)		Conversion Loss type (dB)	Pin@1dB (dBm)	Operating Temperature (°C)	Storage Temperature (°C)
			L-R (type)	L-I				
0.01-3	0.01-15	10	25	25	6.5	5	-40~+70	-55~+85