



Test report is for reference only.

TEST REPORT
For
JXWBLB-T-BP-0.5-0.1-LS



Technical Specification

Center Frequency (f0)(MHz)	0.5
1dB Bandwidth(MHz)	0.1 min
Insertion Loss (f0)(dB)	1 max
Rejection(dB)	20 min @ 0.3MHz
	50 min @ 0.05MHz
VSWR	1.5 max
Connector	SMA-Female
Operating Temperature(°C)	-20 ~ +50
Storage Temperature(°C)	-30~+60
Net Weight(Kg)	0.025 Around

Outline Drawing (Size: mm)

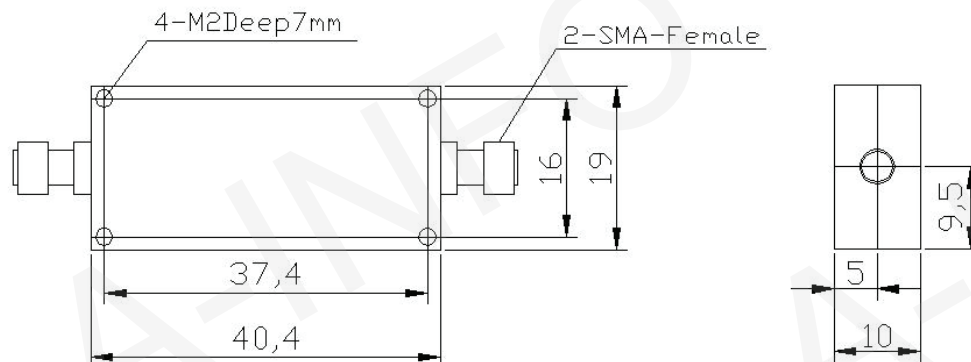

Test Results

Temperature	Insertion Loss (dB)			Rejection (dB)	VSWR
	0.5MHz	0.45MHz	0.55MHz	0.3MHz	
Low Temperature	-1.87	-2.24	-2.04	-27.0	1.4
High Temperature	-1.63	-1.88	-1.94	-26.9	1.4
Room Temperature	-1.65	-2.03	-1.76	-27.3	1.4