

A Type



C Type



Technical Specification

Frequency Range(GHz)	33.0 - 50.0
Gain(dB)	25 Typ.
3dB Beamwidth(deg)	10 Typ.
Waveguide	WR22
Material	Cu
Output	A Type: FUGP400 / C Type: 2.4mm-F
Size(mm) W x H x L	A Type: 59x46x150 / C Type: 59x46x175
Net Weight(Kg)	A Type: 0.15 Around / C Type: 0.20 Around

Outline Drawing (Size: mm)

A Type

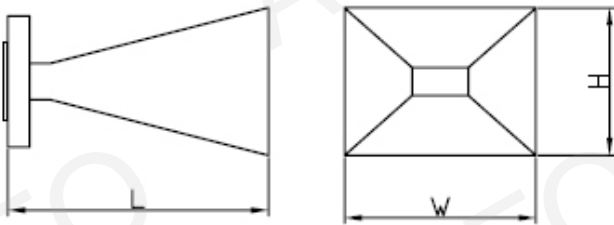

W x H x L: 59x46x150

C Type

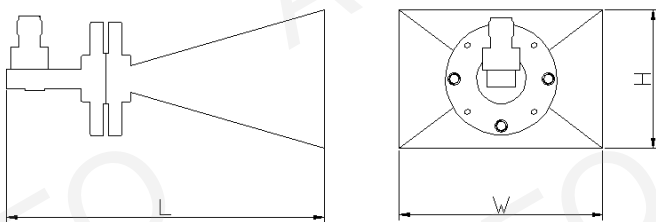

W x H x L: 59x46x175

Flange Drawing

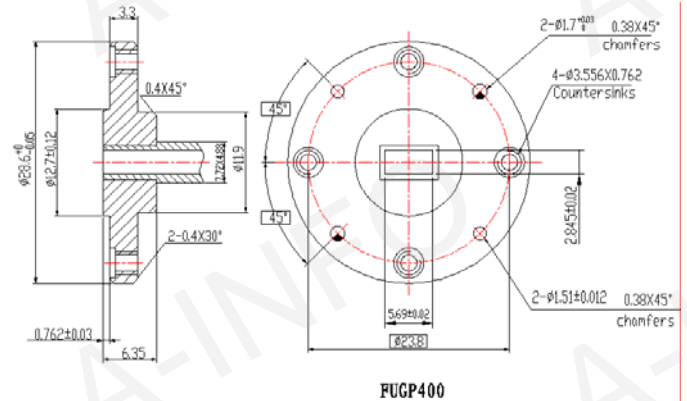

FUGP400

Test Results

Gain

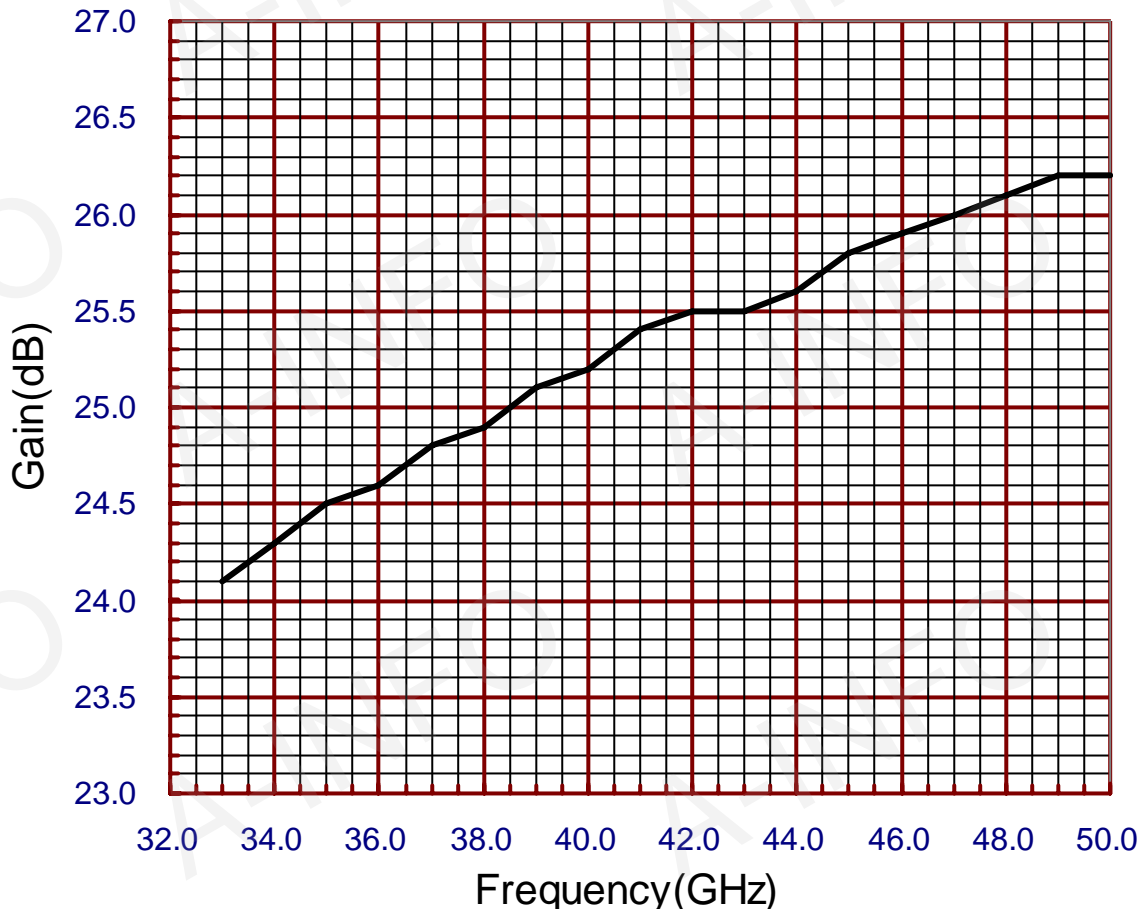

F (GHz)	33.0	34.0	35.0	36.0	37.0	38.0	39.0	40.0	41.0
G (dB)	24.1	24.3	24.5	24.6	24.8	24.9	25.1	25.2	25.4
F (GHz)	42.0	43.0	44.0	45.0	46.0	47.0	48.0	49.0	50.0
G (dB)	25.5	25.5	25.6	25.8	25.9	26.0	26.1	26.2	26.2