



Test report is for reference only.

**TEST REPORT**  
**For**  
**JXWBLA-T-1200-1700-40**



### Technical Specification

|                     |   |
|---------------------|---|
| Freq. Range(GHz)    | 1.2~1.7   |
| Gain(dB)            | 40 min.   |
| Gain Flatness(dB)   | +/-2  |
| Noise Figure(dB)    | 1   |
| Pout @ 1dB(dBm)     | +18   |
| IP3(dBm)            | 30 typ.   |
| VSWR                | 2:1   |
| Supply Voltage(V)   | +12   |
| Supply Current(mA)  | 200   |
| Connector           | SMA-Female for input & output<br>BNC-Female for supply voltage DC |
| Operating Temp.(°C) | -40 ~ +70   |
| Net Weight(Kg)      | 0.23 Around   |

### Outline Drawing (Size: mm)

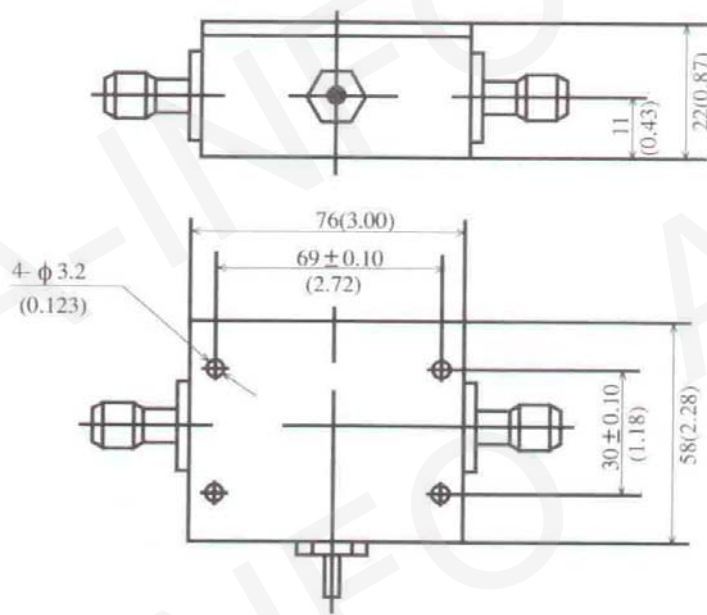

### Test Result

| Gain(dB) | VSWR |
|----------|------|
| 40.89    | 1.98 |