



Test report is for reference only.

**TEST REPORT**  
**For**  
**90WCIC-9400-9900-20-1**



## Technical Specification

Frequency Range(GHz)	9.4 – 9.9
Insertion Loss(dB)	0.35 max
Isolation(dB)	20 min
VSWR	1.2 max
Power Handling(mW)	10
Waveguide	WR90
Flange	FBP100
Operating Temperature(°C)	-40~ +70
Net Weight(Kg)	0.14 Around

## Outline Drawing (Size: mm)

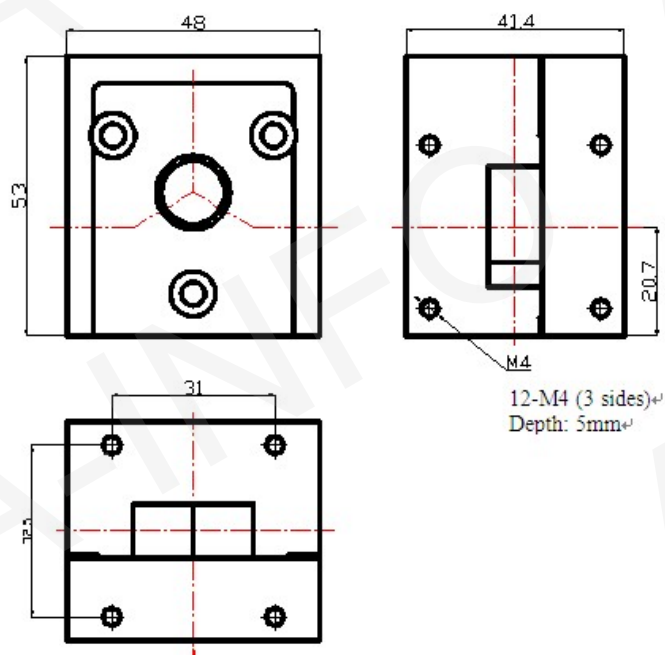

## Test Results

VSWR			Insertion Loss(dB)			Isolation(dB)		
S11	S22	S33	S21	S32	S13	S12	S23	S31
1.14	1.10	1.12	0.18	0.19	0.16	24.2	21.8	23.2