



Test report is for reference only.

**TEST REPORT**  
**For**  
**JXWBKG-T-2-0.5-20-AI**



### Technical Specification

Frequency Range(GHz)	0.5-20
VSWR	2.0 max
Insertion Loss(dB)	4.5 max
Isolation(dB)	60 min
Switching Speed (ns)	50 max
Power Handling( W)	0.5
Operating Temperature(°C)	-55~ +85
Storage Temperature(°C)	-65~ +125
Material	Al
Net Weight(Kg)	0.015 Around

### Outline Drawing (Size: mm)

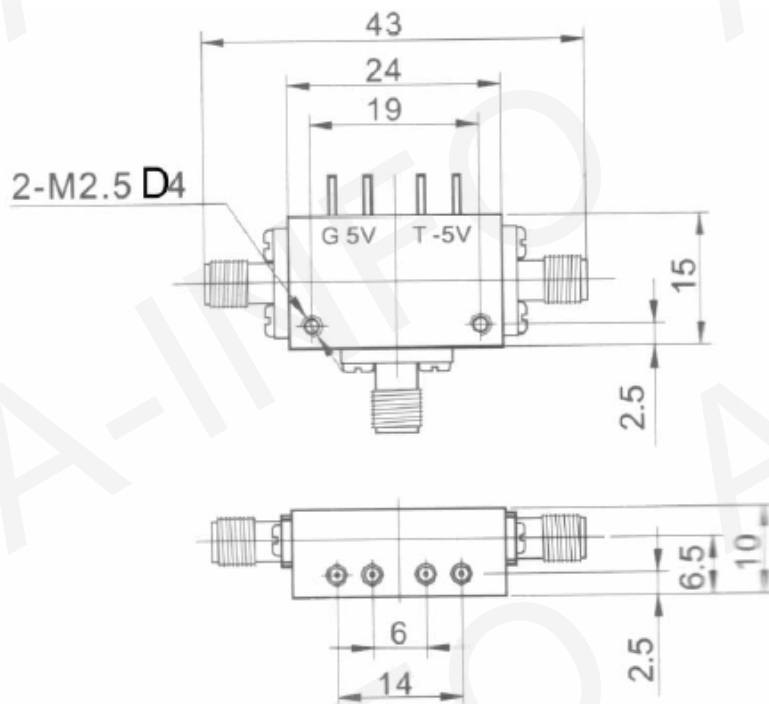

### Test Results

Frequency(GHz)	Port	Insertion Loss(dB)		VSWR	Isolation(dB)	Switching Speed(ns)
		min	max	max		
0.5-20	J0→J1 1	1.00	3.77	1.85	70 min	50 max
	J0→J2 0	0.98	2.76	1.74		