



Test report is for reference only.

TEST REPORT
For
JXWBKG-T-2-0.5-18

Technical Specification

Frequency Range(MHz)	0.5-18
Insertion Loss(dB)	3.5 max
VSWR	2.0 max
Isolation(dB)	60 min
Switching Speed(ns)	50
Power Handling(W)	1 CW max
Connector	SMA-Female
Operating Temperature(°C)	-40 ~ +70
Storage Temperature (°C)	-55 - +85
Net Weight(Kg)	0.085 Around

Outline Drawing (Size: mm)

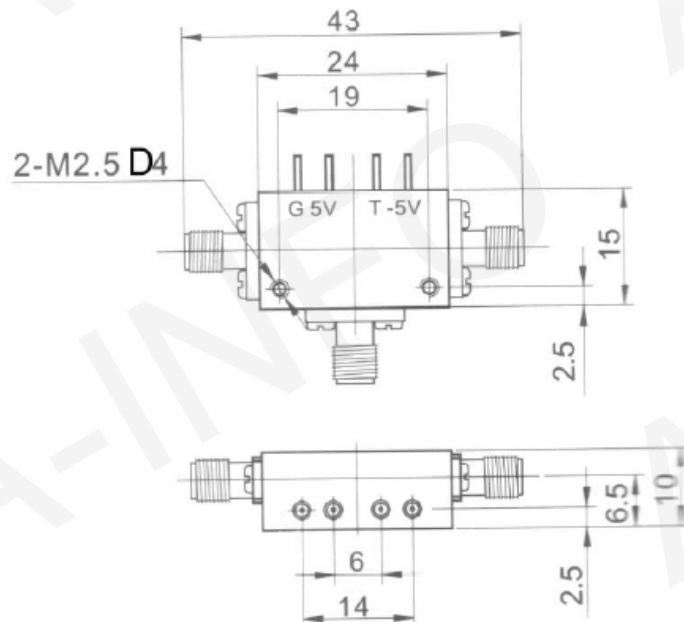

Test Results

Port	Frequency (GHz)	Insertion Loss(dB)	VSWR	Isolation(dB)
		max	max	min
J0-J1	0.5-18	3.32	1.78	69.0
J0-J2	0.5-18	3.12	1.88	70.0