



Test report is for reference only.

**TEST REPORT**  
**For**  
**JXWBPLO-3100**



## Technical Specification

Frequency(MHz)	3100
Level(dBm)	+10
Phase Noise (dBc/Hz)	-100 @1KHz
Spurious(dBc)	-75
Frequency Stability(KHz)	±4(-20°C ~ +70°C)
Power Supply(V/mA)	+12/160
Connector	SMA-Female
Operating Temperature(°C)	-20 - +70
Net Weight(Kg)	0.1 Around

## Outline Drawing (Size: mm)

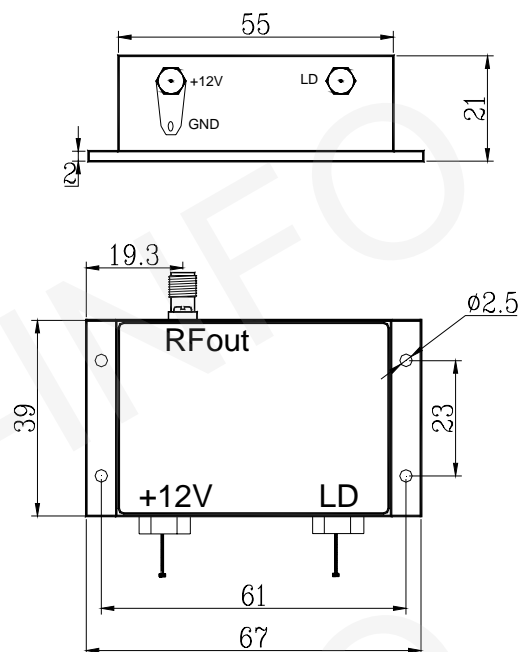

## Test Results

Temp.	Spec.	Frequency	Level	Phase Noise	Spurious	Harmonics	Frequency Stability	Power Supply
		(MHz)	(dBm)	(dBc/Hz)	(dBc)	(dBc)	(KHz)	(V/mA)
		<b>3100</b>	<b>+10</b>	<b>-100 @1KHz</b>	<b>-75</b>	<b>-</b>	<b>±4(-20°C- +70°C)</b>	<b>+12/160</b>
+25 °C		3100	+12.3	-100.5	-83	-47	+0.30	+12/60
-20 °C		3100	+12.5	-100.3	-81	-44	+1.00	+12/60
+70 °C		3100	+12.1	-100.3	-78	-48	-2.00	+12/60