



Test report is for reference only.

**TEST REPORT**  
**For**  
**JXWBHX-T-695-750-25-150**

## Technical Specification

Frequency Range( MHz)	695-750
Insertion Loss( dB)	0.3 max
Isolation( dB)	25 min
VSWR	1.15 max
Forward Power( W)	150
Reverse Power( W)	60
Connector	N-Female
Operating Temp.(°C)	-40 ~+70
Net Weight(Kg)	0.15 Around

## Outline Drawing (Size: mm)

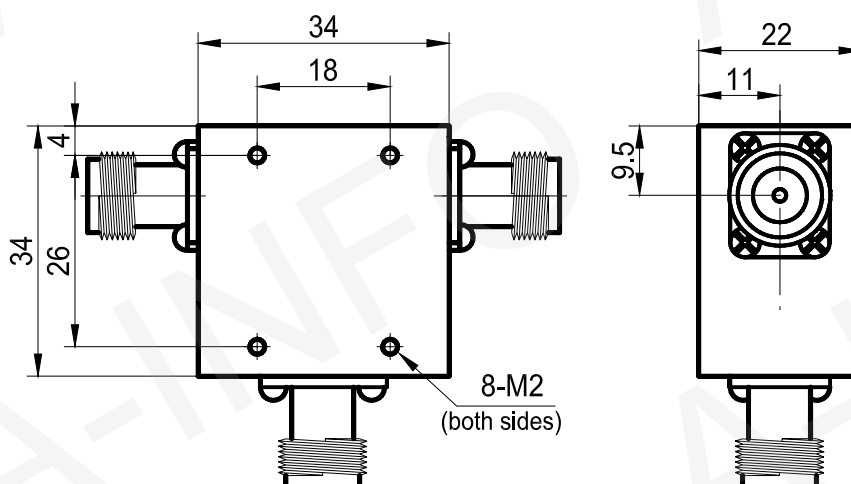

## Test Results

Insertion Loss(dB)			Isolation (dB)			VSWR		
1-2	2-3	3-1	2-1	3-2	1-3	S1	S2	S3
0.26	0.27	0.28	27.0	30.0	29.0	1.07	1.08	1.07