



Test report is for reference only.

**TEST REPORT**  
**For**  
**JXWBHX-T-2400-2500-25-10\_N**



### Technical Specification

Frequency Range(GHz)	2.4 – 2.5
Insertion Loss(dB)	0.3 max
VSWR	1.20 max
Isolation(dB)	25 min
Power Handling(W)	10 CW
Connector	N-Female
Operating Temperature(°C)	-40 ~ +70
Storage Temperature(°C)	-55 ~ +85
Net Weight(Kg)	0.1 Around

### Outline Drawing (Size: mm)

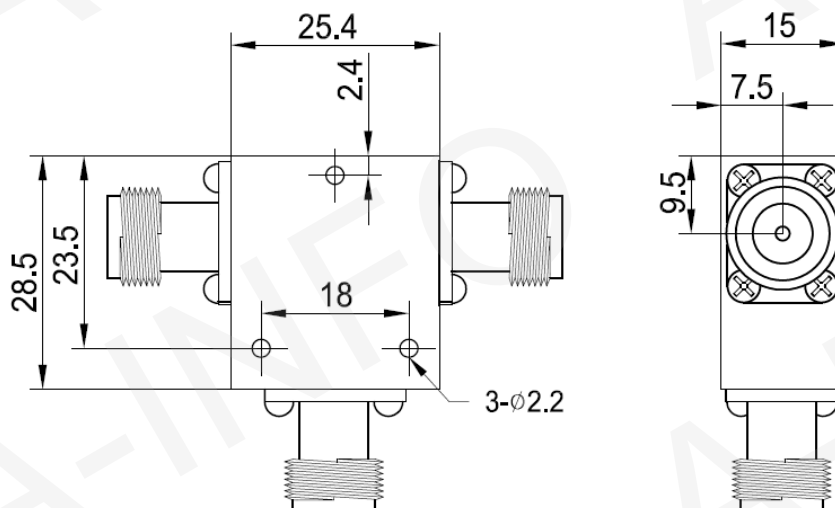

### Test Results

Insertion Loss (dB)			Isolation (dB)			VSWR			High Temperature (°C)			Low Temperature (°C)		
1-2	2-3	3-1	2-1	3-2	1-3	S1	S2	S3	a+	a-	S	a+	a-	S
0.22	0.23	0.21	29.3	28.7	31.1	1.11	1.09	1.08	0.23	27.7	1.15	0.20	26.6	1.13