



Test report is for reference only.

TEST REPORT
For
JXWBHX-T-1200-1400-18-1

Technical Specification

Freq. Range(GHz)	1.2-1.4
VSWR	1.3 max
Insertion Loss(dB)	0.4 max
Isolation(dB)	18 min
Forward Power (W)	1
Connectors	SMA-Female
Operating Temperature(°C)	-40 ~ +70
Net Weight(Kg)	0.055 Around

Outline Drawing (Size: mm)

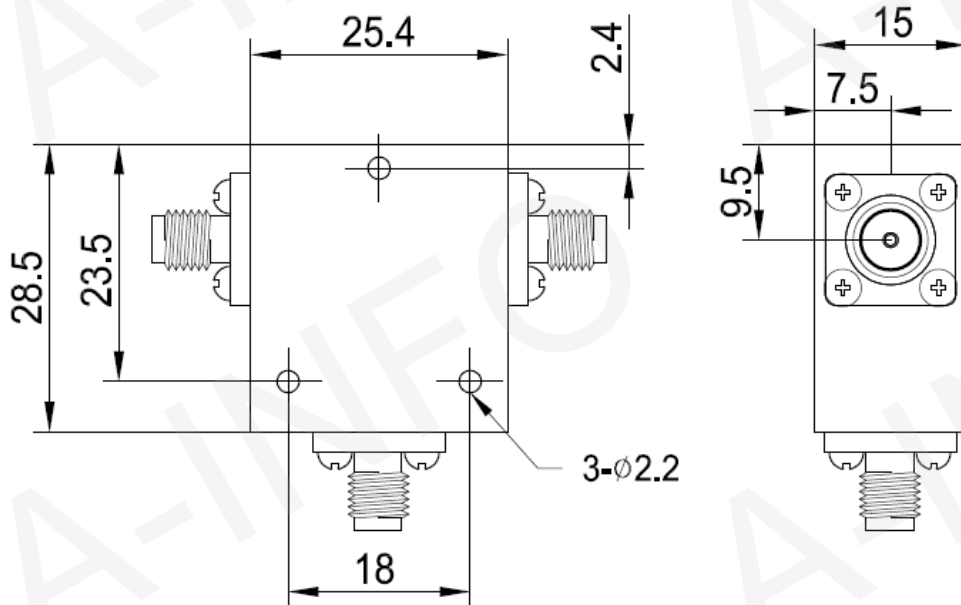

Test Result

Insertion Loss (dB)			Isolation(dB)			VSWR		
1-2	2-3	3-1	2-1	3-2	1-3	S1	S2	S3
0.30	0.32	0.31	20	25	21	1.15	1.12	1.10