

Test report is for reference only.

TEST REPORT
For
JXWBGL-T-6000-10000-18-5



Technical Specification

Frequency Range(GHz)	6-10
Insertion Loss(dB)	0.6 max
Isolation(dB)	18 min
VSWR	1.4:1 max
Average Power(W)	5 CW
Peak Power(W)	50 CW
Operating Temperature(°C)	-30 ~ +85
Connector	SMA-Female
Directional	From left to right
Net Weight(Kg)	0.025 Around

Outline Drawing (Size: mm)

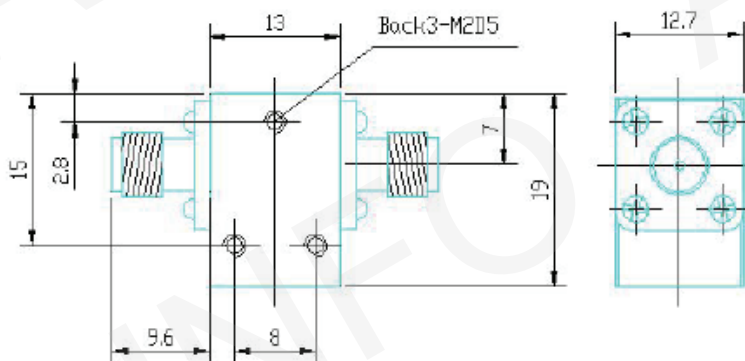

Test Results

Frequency Range(GHz)	Insertion Loss(dB)	Isolation(dB)	VSWR
6-10	0.59 max	18 min	1.35