

Test report is for reference only.

TEST REPORT
For
JXWBGL-T-2000-3000-20-10



Technical Specification

Frequency Range(GHz)	2-3
Insertion Loss(dB)	0.5 max
Isolation(dB)	20 min
Forward Power(W)	10 CW
Reverse Power(W)	5 CW
VSWR	1.25 max
Connector	SMA-Female
Operating Temperature(°C)	-30 ~ +75

Outline Drawing (Size: mm)

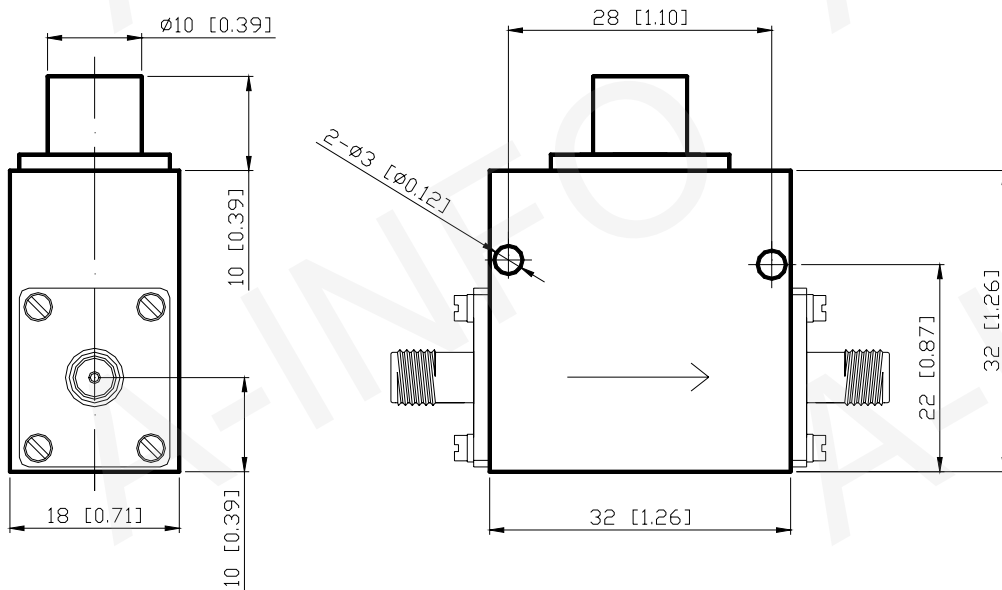

Test Results

25°C			-30°C			+75°C		
Insertion Loss (dB)	VSWR	Isolation (dB)	Insertion Loss (dB)	VSWR	Isolation (dB)	Insertion Loss (dB)	VSWR	Isolation (dB)
0.42	1.23	23.60	0.43	1.23	22.80	0.44	1.24	23.80