



Test report is for reference only.

TEST REPORT
For
JXWBGL-T-1200-1400-18-1

Technical Specification

Freq. Rang(GHz)	1.2-1.4
VSWR	1.3 max
Insertion Loss(dB)	0.4 max
Isolation(dB)	18 min
Forward Power(W)	1
Reverse Power(W)	1
Connectors	SMA-Female
Operating Temp. (°C)	-40 ~ +70
Net Weight(Kg)	0.055 Around

Outline Drawing (Size: mm)

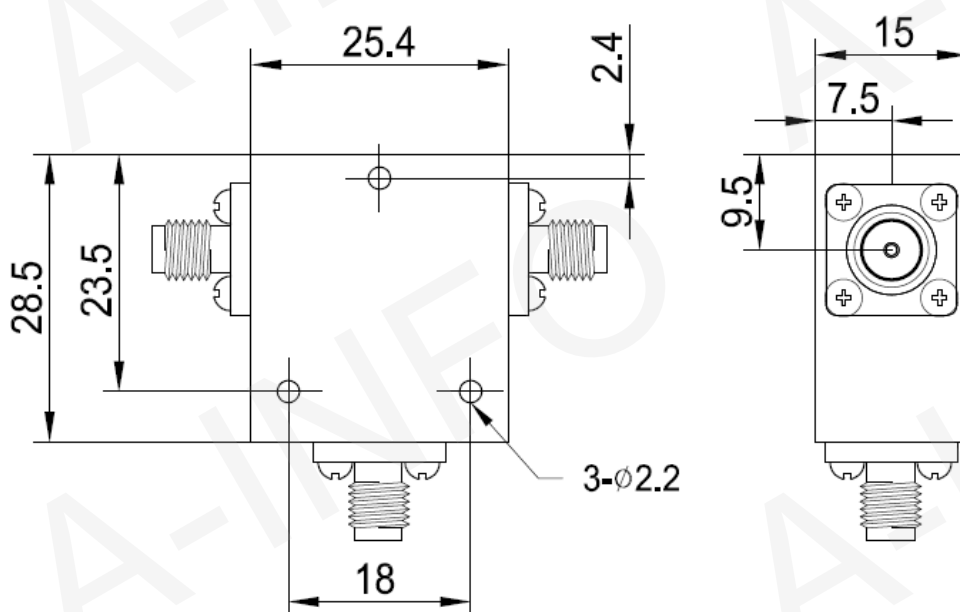

Test Results

Insertion Loss(dB)	VSWR	Isolation(dB)
0.25	1.10	21.05